

Soils Map

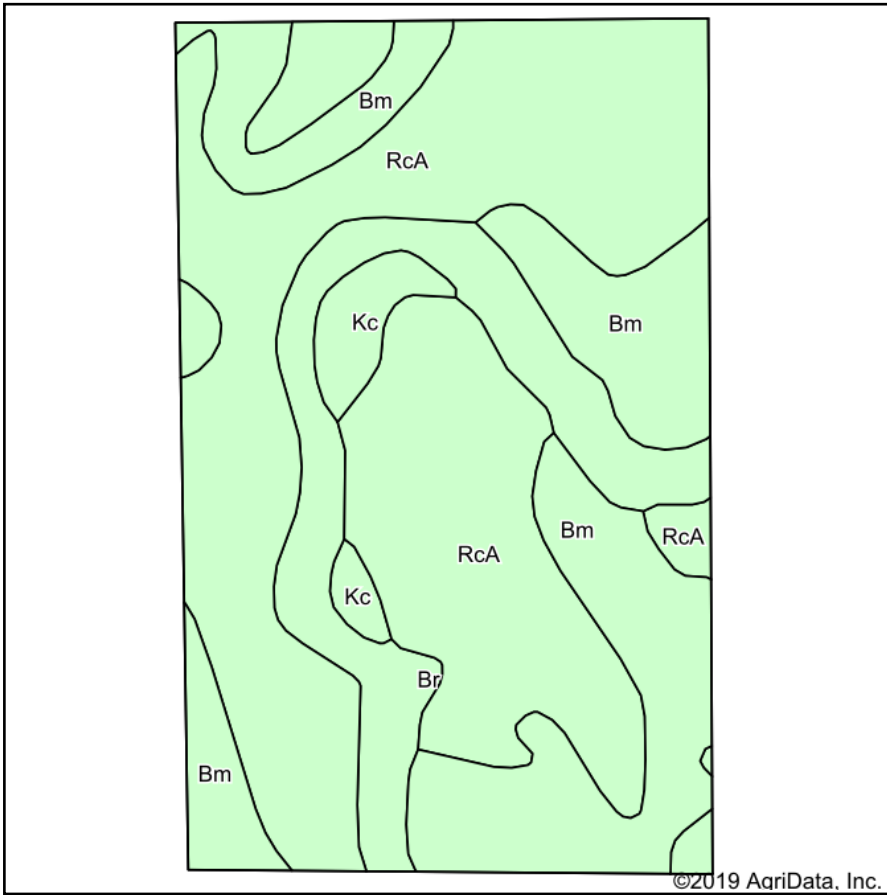

Soils data provided by USDA and NRCS.

©2019 AgriData, Inc.

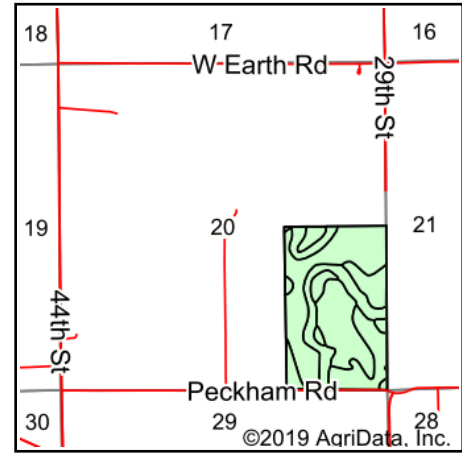

State: **Oklahoma**
 County: **Kay**
 Location: **20-28N-1W**
 Township: **Braman**
 Acres: **98.75**
 Date: **3/25/2019**



Area Symbol: OK071, Soil Area Version: 15

Code	Soil Description	Acres	Percent of field	Non-Irr Class *c	Range Production (lbs/acre/yr)	Alfalfa hay	Cotton lint	Grain sorghum	Improved bermudagrass	Wheat	Weeping lovegrass	Peanuts	Soybeans	*n NCCPI Overall	*n NCCPI Corn	*n NCCPI Small Grains	
RcA	Reinach loam, 0 to 1 percent slopes, rarely flooded	54.28	55.0%	Iw	6052	5	485	54		9	34	7	34	1	70	45	49
Bm	Brewer silty clay loam, 0 to 1 percent slopes, rarely flooded	27.56	27.9%	Iw	4210	4	500	55		7	35				57	42	47
Br	Ashport, Port, and Pulaski soils, 0 to 1 percent slopes, frequently flooded	13.74	13.9%	Vw	6247					8					48	37	48
Kc	Port silty clay loam, 0 to 1 percent slopes, occasionally flooded	3.17	3.2%	IIw	6049	5	26	50		9	35		48		59	41	35
Weighted Average					5565	4	407	46.6		8.3	29.6	3.8	20.2	0.5	*n 63	*n 42.9	*n 47.9

*n: The aggregation method is "Weighted Average using major components"

*c: Using Capabilities Class Dominant Condition Aggregation Method

Soils data provided by USDA and NRCS.