

# Soils Map

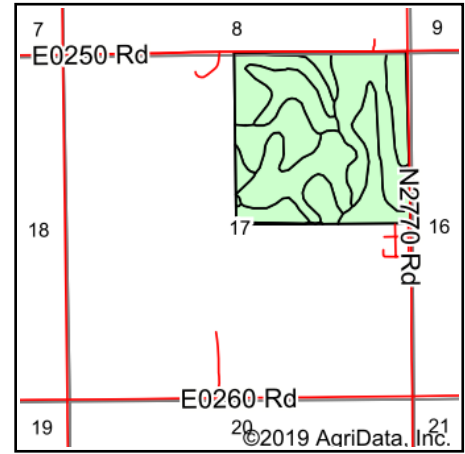

State: **Oklahoma**  
 County: **Grant**  
 Location: **17-25N-8W**  
 Township: **Southwest Grant**  
 Acres: **160.7**  
 Date: **4/15/2019**

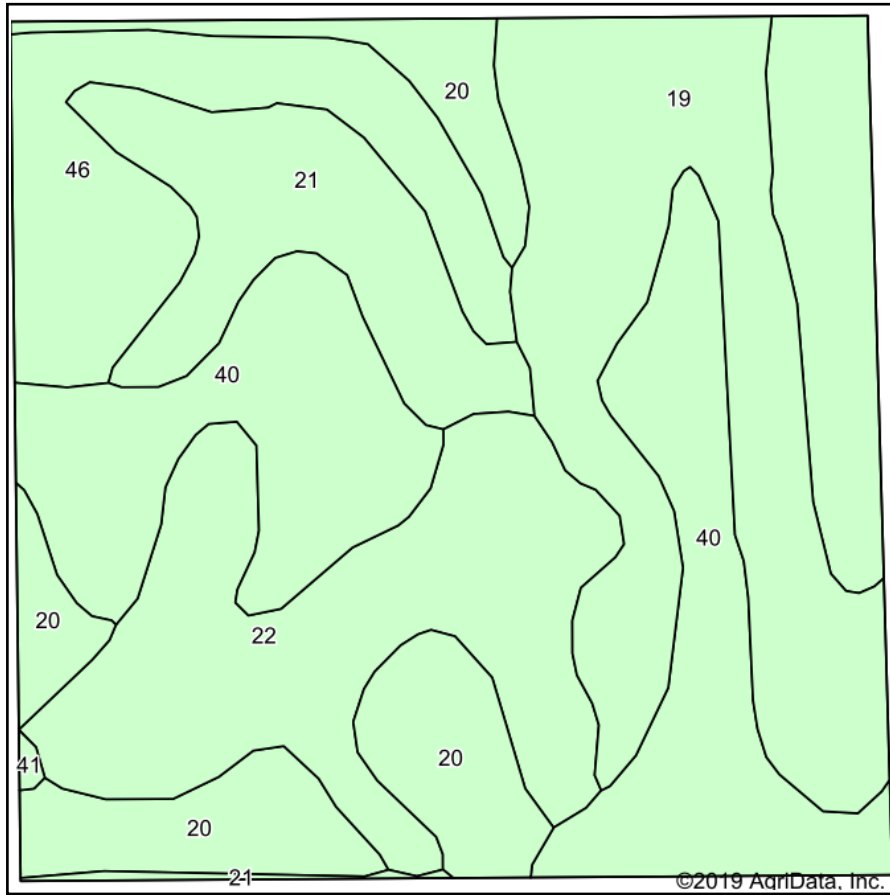

Maps Provided By:



© AgriData, Inc. 2019

www.AgrIDataInc.com



## Area Symbol: OK053, Soil Area Version: 15

Cod e	Soil Description	Acres	Percent of field	Non-Irr Class *c	Irr Class *c	Range Production (lbs/acre/yr)	Cotton lint	Grain sorghum	Improved bermudagrass	Introduced bluestem	Weeping lovegrass	Wheat	Small grains grazeout	Caucasian bluestem	Alfalfa hay	Barley
40	Pond Creek silt loam, 1 to 3 percent slopes	45.10	28.1%	Ie	Ie	4747	32	50		5	5	35			4	
19	Grant silt loam, 3 to 5 percent slopes, eroded	33.73	21.0%	IIle		0	248	30		5	4	5	20	3	5	
22	Grant-Port, frequently flooded, complex, 0 to 12 percent slopes	28.87	18.0%	VIle		5064	44	30		5	5	1	22		3	1
20	Grant-Kingfisher complex, 5 to 8 percent slopes	20.24	12.6%	IVe		4627	42	19		5	5	25				6
46	Ironmound-Nash complex, 3 to 12 percent slopes	17.37	10.8%	VIle		4028	20	2		3	3	3				
21	Grant-Kingfisher complex, 5 to 8 percent slopes, eroded	15.17	9.4%	IVe		0	19	17		4	5	22				2

41	Port silt loam, 0 to 1 percent slopes, occasionally flooded	0.22	0.1%	Ilw		6112	13	49	9			34			5	
<b>Weighted Average</b>						<b>3268.5</b>	<b>78.2</b>	<b>30</b>	<b>4.7</b>	<b>4.6</b>	<b>1.2</b>	<b>23.6</b>	<b>0.6</b>	<b>1.6</b>	<b>1.3</b>	<b>1.3</b>

\*n: The aggregation method is "Weighted Average using major components"

\*c: Using Capabilities Class Dominant Condition Aggregation Method

Soils data provided by USDA and NRCS.