

# Soils Map

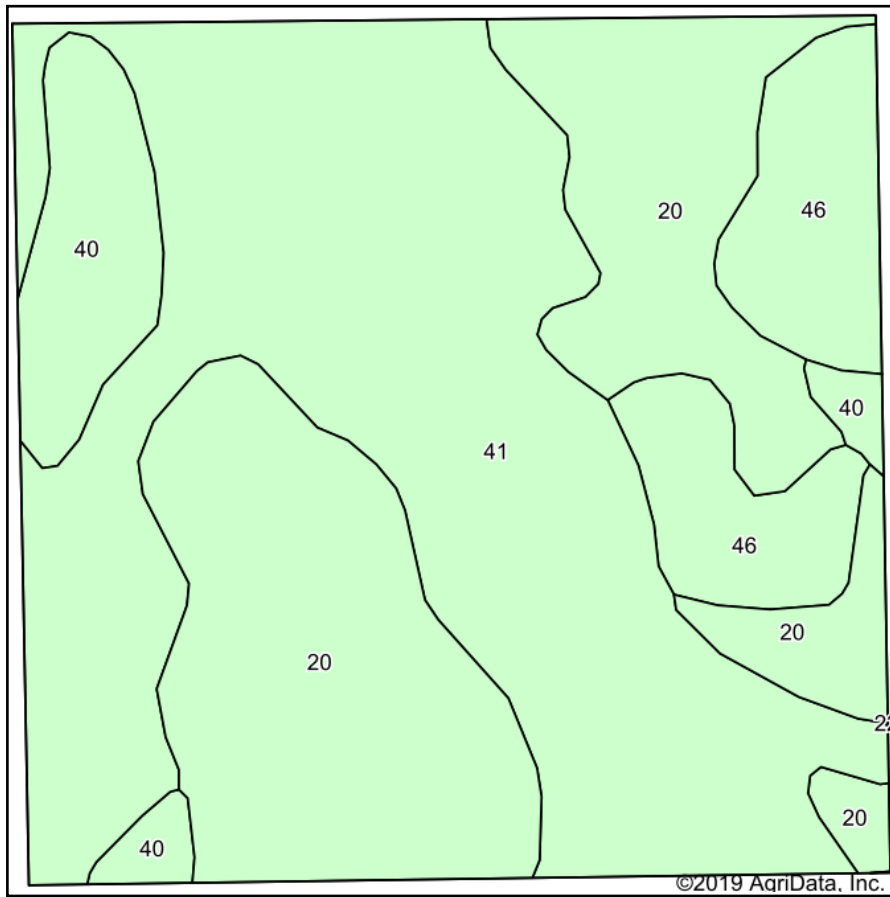

Soils data provided by USDA and NRCS.

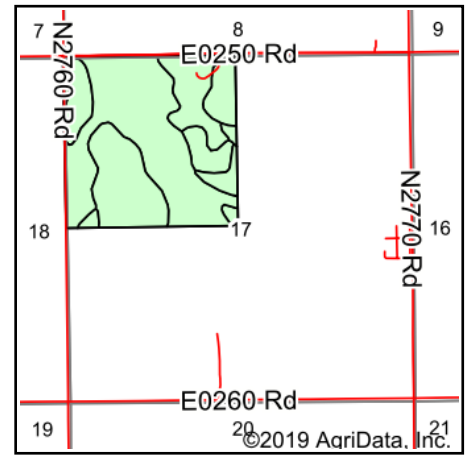

State: **Oklahoma**  
 County: **Grant**  
 Location: **17-25N-8W**  
 Township: **Southwest Grant**  
 Acres: **158.8**  
 Date: **4/15/2019**



Maps Provided By:



© AgriData, Inc. 2019

www.AgriDataInc.com



## Area Symbol: OK053, Soil Area Version: 15

Cod e	Soil Description	Acres	Percent of field	Non-Irr Class *c	Irr Class *c	Range Production (lbs/acre/yr)	Improved bermudagrass	Wheat	Barley	Oats	Introduced bluestem	Tall wheatgrass	Alfalfa hay	Cotton lint	Grain sorghum	Weeping lovegrass	C bl
41	Port silt loam, 0 to 1 percent slopes, occasionally flooded	76.10	47.9%	Ilw		6112		9	34				5	13	49		
20	Grant-Kingfisher complex, 5 to 8 percent slopes	54.16	34.1%	IVe		4627		5	25	6	2	5	2	42	19		
46	Ironmound-Nash complex, 3 to 12 percent slopes	16.87	10.6%	VIe		4028		3	3			3		20	2		
40	Pond Creek silt loam, 1 to 3 percent slopes	11.67	7.3%	Ie	Ie	4747		5	35			5	4	32	50		
<b>Weighted Average</b>						<b>5283.8</b>		<b>6.7</b>	<b>27.7</b>	<b>2</b>	<b>0.7</b>	<b>2.4</b>	<b>0.7</b>	<b>2.7</b>	<b>25</b>	<b>33.8</b>	<b>*-</b>

\*n: The aggregation method is "Weighted Average using major components"

\*c: Using Capabilities Class Dominant Condition Aggregation Method

Soils data provided by USDA and NRCS.