

# Soils Map

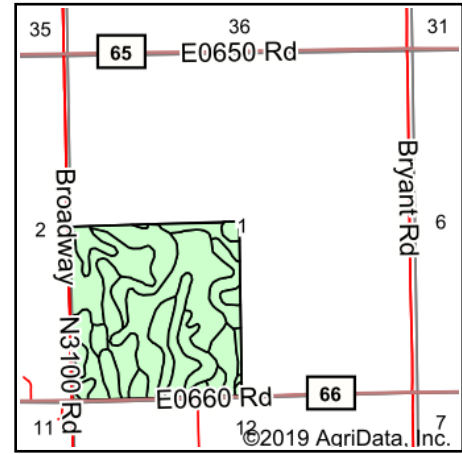

State: **Oklahoma**  
 County: **Logan**  
 Location: **1-18N-3W**  
 Township: **North Logan**  
 Acres: **161.16**  
 Date: **4/17/2019**

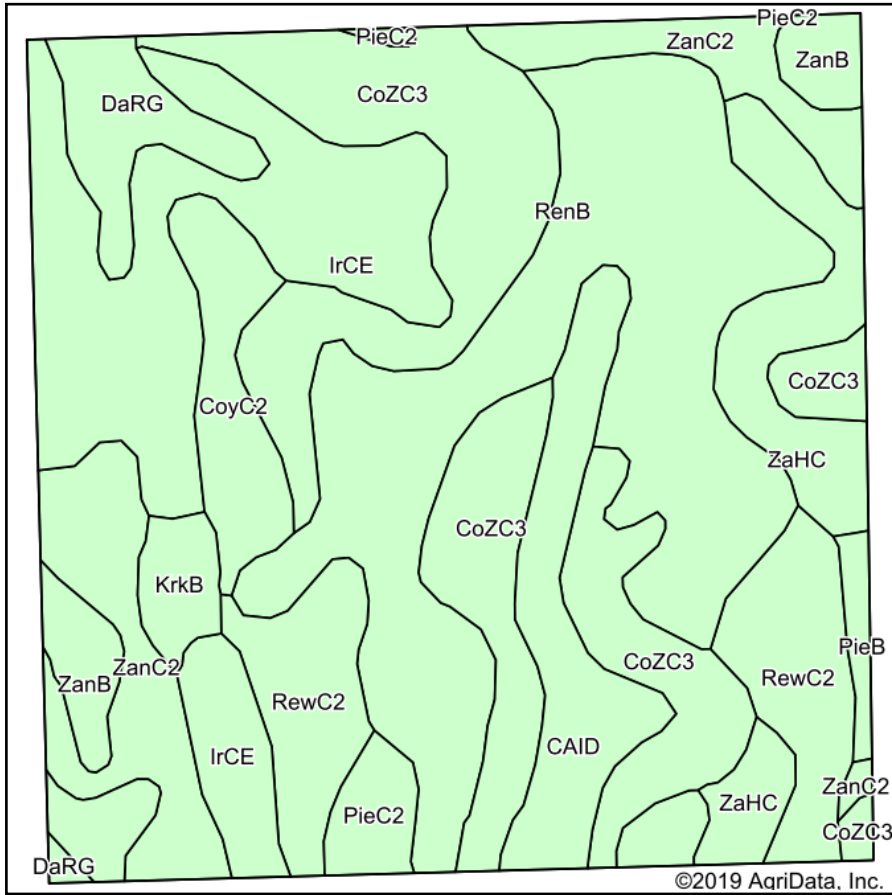

Maps Provided By:  
**surety**  
 CUSTOMIZED ONLINE MAPPING  
 © AgriData, Inc. 2019 www.AgriDataInc.com



## Area Symbol: OK083, Soil Area Version: 17

Code	Soil Description	Acres	Percent of field	Non-Irr Class *c	Irr Class *c	Range Production (lbs/acre/yr)	Improved bermudagrass	Introduced bluestem	Wheat	Barley	Oats	Tall wheatgrass	Alfalfa hay	Weeping lovegrass	Wheat grazeout	Cotton lint
RenB	Renfrow silt loam, 1 to 3 percent slopes	36.97	22.9%	IIle	IIIs	3969	3	1	30	30						22
CoZC3	Coyle and Zaneis soils, 3 to 5 percent slopes, severely eroded	32.09	19.9%	VIle		0	3							3		
IrCE	Ironmound-Coyle complex, 5 to 15 percent slopes	25.62	15.9%	VIIs		3694	3	1	16			1	1	2	1	
RewC2	Renfrow silty clay loam, 3 to 5 percent slopes, eroded	14.05	8.7%	IVle		0	3									
ZanC2	Zaneis loam, 3 to 5 percent slopes, eroded	13.27	8.2%	IIle		0	6							6		
ZaHC	Zaneis-huska complex, 3 to 5 percent slopes	9.56	5.9%	IIle		4126	4	4	19	1	1	3	1	3	2	

CAID	Coyle-Ashport frequently flooded-Ironmound complex, 1 to 8 percent slopes	8.90	5.5%	IVe		4713	5	5	12	1	1	3	1	2	1	5
CoyC2	Coyle loam, 3 to 5 percent slopes, eroded	5.76	3.6%	IVe		0	4		15					4		
DaRG	Darnell-Rock outcrop complex, 8 to 45 percent slopes	5.00	3.1%	VIIe		1740										
ZanB	Zaneis loam, 1 to 3 percent slopes	3.91	2.4%	IIe		4705	6		30	2			3	5		31
PieC2	Piedmont silty clay loam, 3 to 5 percent slopes, eroded	2.53	1.6%	IVe		0	4	4	15			3				2
KrkB	Kirkland silty clay loam, 1 to 3 percent slopes	2.32	1.4%	IIIe		3853	4	5	29		1	4	2	4		4
PieB	Piedmont silty clay loam, 1 to 3 percent slopes	1.18	0.7%	IIIs		3849	4	5	24			4	2			3
<b>Weighted Average</b>						<b>2254.5</b>	<b>3.5</b>	<b>1.1</b>	<b>13.3</b>	<b>7</b>	<b>0.1</b>	<b>0.6</b>	<b>0.4</b>	<b>2</b>	<b>0.4</b>	<b>59.</b>

\*n: The aggregation method is "Weighted Average using major components"

\*c: Using Capabilities Class Dominant Condition Aggregation Method

Soils data provided by USDA and NRCS.