

Soils Map

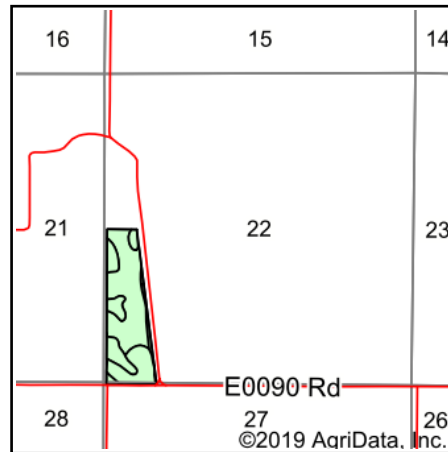

State: **Oklahoma**
 County: **Harper**
 Location: **22-28N-23W**
 Township: **Buffalo**
 Acres: **41.7**
 Date: **6/12/2019**

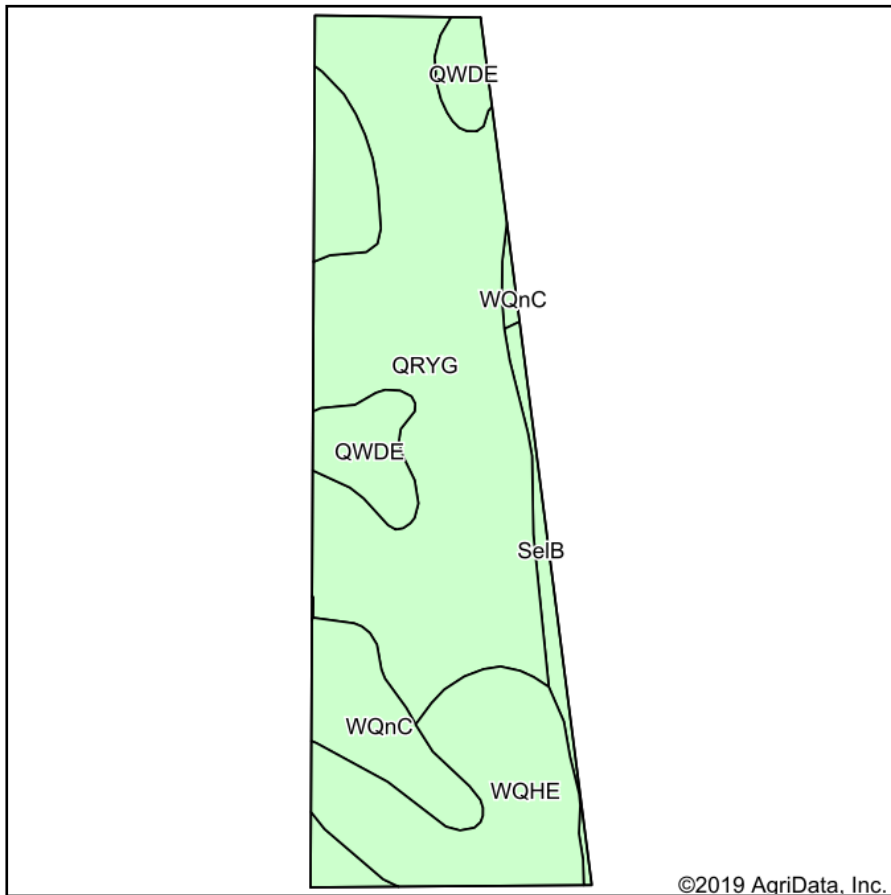
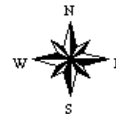

Soils data provided by USDA and NRCS.

Area Symbol: OK059. Soil Area Version: 14

Code	Soil Description	Acres	Percent of field	Non-Irr Class *c	Irr Class *c	Range Production (lbs/acre/yr)	Barley	Grain sorghum	Grain sorghum Irrigated	Improved bermudagrass	Introduced bluestem	Weeping lovegrass	Wheat	Wheat Irrigated	Cotton lint	Co lint Irri
QRYG	Quinlan-Rock outcrop-Yomont complex, 0 to 45 percent slopes	22.87	54.8%	Vlle		2473										
WQHE	Westola-Quinlan-Hardeman complex, 0 to 12 percent slopes	8.08	19.4%	Vle		3534							14	22		
QWDE	Quinlan-Woodward-Deepwood complex, 5 to 12 percent slopes	5.19	12.4%	Vle		2432	11	28	2		3	4	3	18	1	113
WQnC	Woodward-Quinlan complex, 3 to 5 percent slopes	4.34	10.4%	Ills		3174	11	28			4	4	4	18		165
SelB	Selman silt loam, 1 to 3 percent slopes	1.22	2.9%	Ile	Ile	4108		44	105			6	33	55	13	
Weighted Average						2794.3	2.5	7.7	3.3	0.8	1.1	0.8	7.8	6	31.6	

*n: The aggregation method is "Weighted Average using major components"

*c: Using Capabilities Class Dominant Condition Aggregation Method

Soils data provided by USDA and NRCS.