

Soils Map

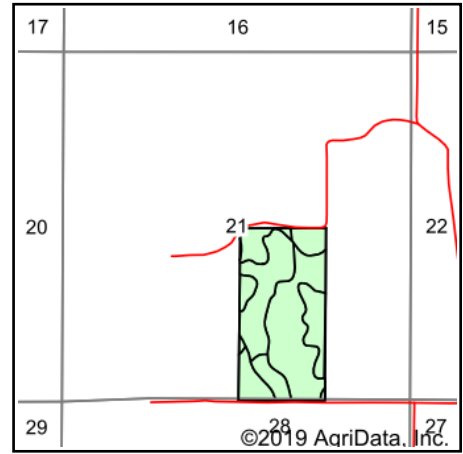

State: **Oklahoma**
 County: **Harper**
 Location: **21-28N-23W**
 Township: **Buffalo**
 Acres: **78.91**
 Date: **6/12/2019**

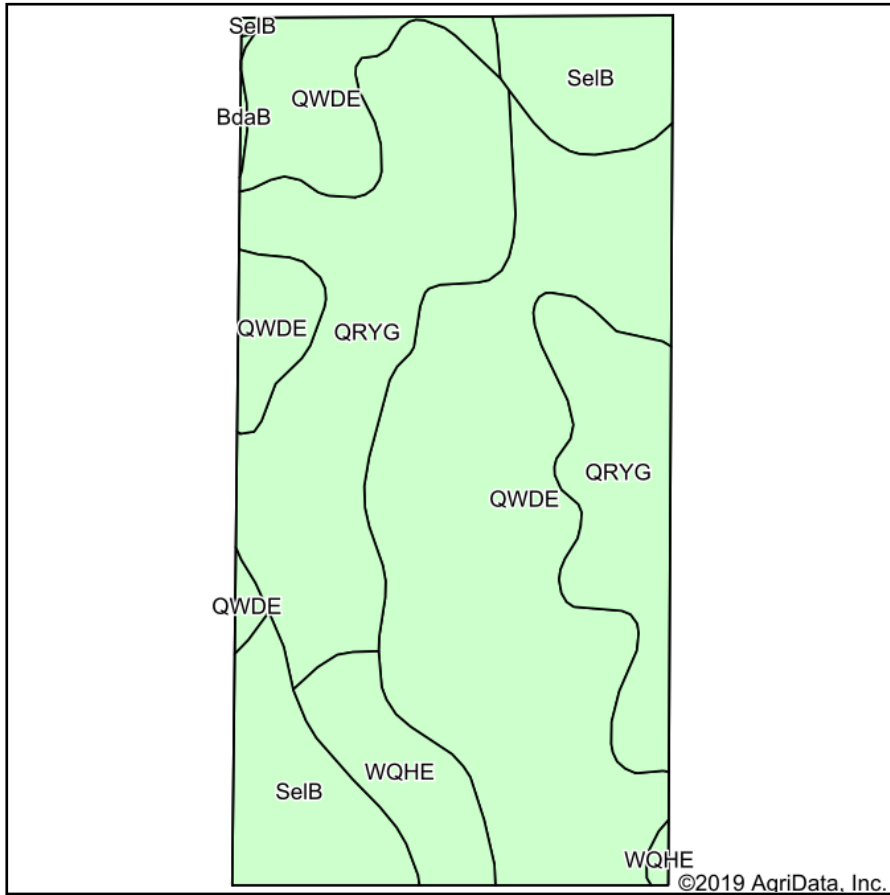

Maps Provided By:



Area Symbol: OK059, Soil Area Version: 14

Code	Soil Description	Acres	Percent of field	Non-Irr Class *c	Irr Class *c	Range Production (lbs/acre/yr)	Cotton lint	Cotton lint Irrigated	Grain sorghum	Grain sorghum Irrigated	Wheat	Wheat Irrigated	Barley	Improved bermudagrass	Introduced bluestem	Wheat
QWDE	Quinlan-Woodward-Deepwood complex, 5 to 12 percent slopes	37.04	46.9%	Vle		2432	113		28	2	18	1	11	3	4	
QRYG	Quinlan-Rock outcrop-Yomont complex, 0 to 45 percent slopes	26.72	33.9%	Vlle		2473										
SelB	Selman silt loam, 1 to 3 percent slopes	10.27	13.0%	Ile	Ile	4108	13	40	44	105	33	55				6
WQHE	Westola-Quinlan-Hardeman complex, 0 to 12 percent slopes	4.75	6.0%	Vle		3534					14	22				
BdaB	Berda loam, 1 to 3 percent slopes, cool	0.13	0.2%	IIlc	IIle	1566	392	783	1218	2436	17	35				
Weighted Average						2728.9	55.4	6.5	20.9	18.6	13.6	9	5.2	1.4	2.7	

*n: The aggregation method is "Weighted Average using major components"

*c: Using Capabilities Class Dominant Condition Aggregation Method

Soils data provided by USDA and NRCS.