

Soils Map

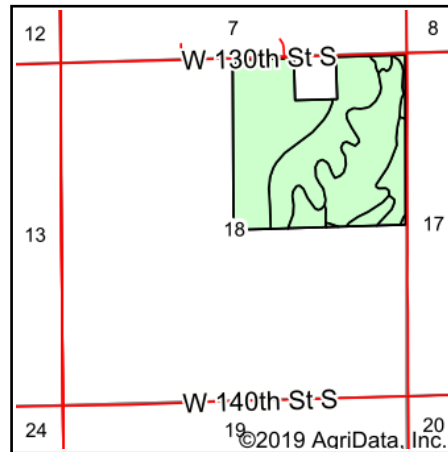

State: **Kansas**
 County: **Sumner**
 Location: **18-34S-4W**
 Township: **Bluff**
 Acres: **149.9**
 Date: **10/30/2019**

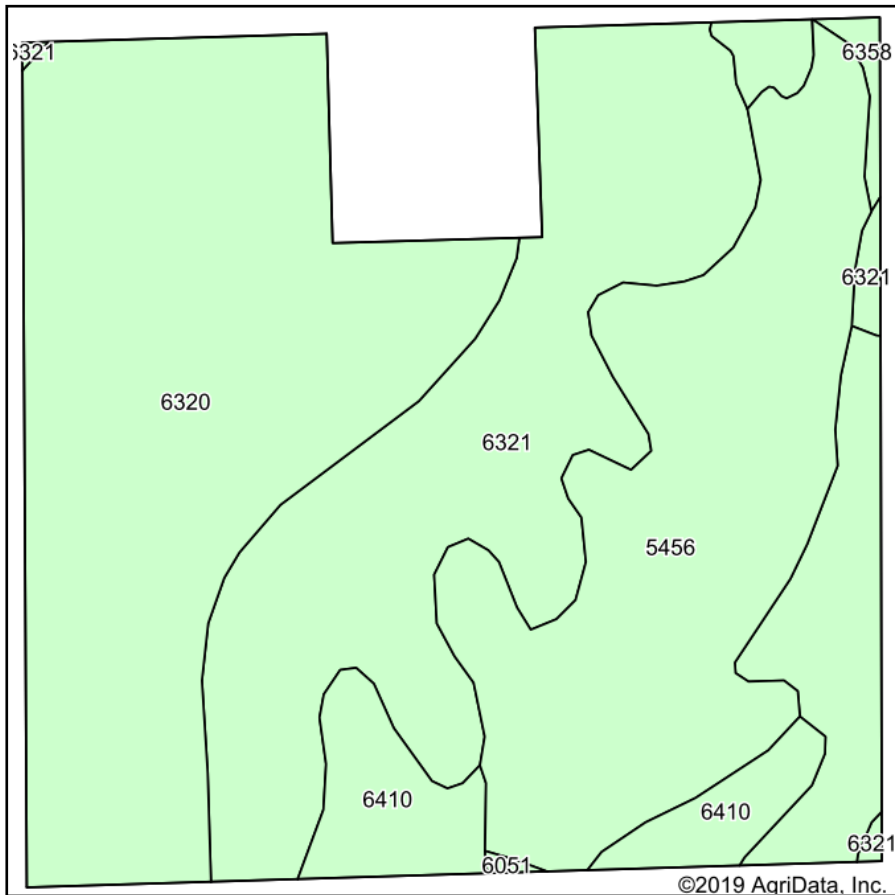

Maps Provided By:



Soils data provided by USDA and NRCS.

Area Symbol: KS191, Soil Area Version: 15

Code	Soil Description	Acres	Percent of field	Non-Irr Class *c	Irr Class *c	Range Production (lbs/acre/yr)	Grain sorghum	Improved bermudagrass	Introduced bluestem	Wheat	Oats	Barley	Cotton lint	Alfalfa hay	Winter wheat	Peanuts	Tall wheat
6320	Bethany silt loam, 0 to 1 percent slopes	63.53	42.4%	Ile	Ile	4633	44	5	5	31	2	2	276				
6321	Bethany silt loam, 1 to 3 percent slopes	39.55	26.4%	Ile	Ils	4633	44	5	5	30	2	2	302				
5456	Wellsford-Elandco complex, 0 to 25 percent slopes	37.34	24.9%	Vle		3050	11	2									
6410	Pond Creek silt loam, 3 to 6 percent slopes	8.51	5.7%	IIIe	IIIe	4747	50	5	5	35			25	4		85	
6358	Kirkland silty clay loam, 1 to 3 percent slopes, eroded	0.81	0.5%	IVe		2800	30	4							24		
6051	Elandco silt loam, frequently flooded	0.16	0.1%	Vw		4418											
Weighted Average						4235	36	4.2	3.7	23	1.4	1.4	198.1	0.2	0.1	4.8	

*n: The aggregation method is "Weighted Average using major components"

*c: Using Capabilities Class Dominant Condition Aggregation Method

Soils data provided by USDA and NRCS.