

Soils Map

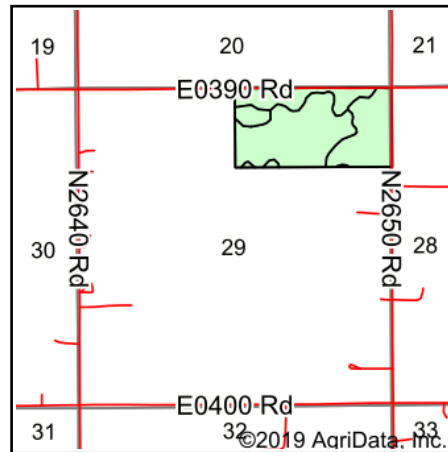

State: **Oklahoma**
 County: **Major**
 Location: **29-23N-10W**
 Township: **East Major**
 Acres: **79.73**
 Date: **11/7/2019**

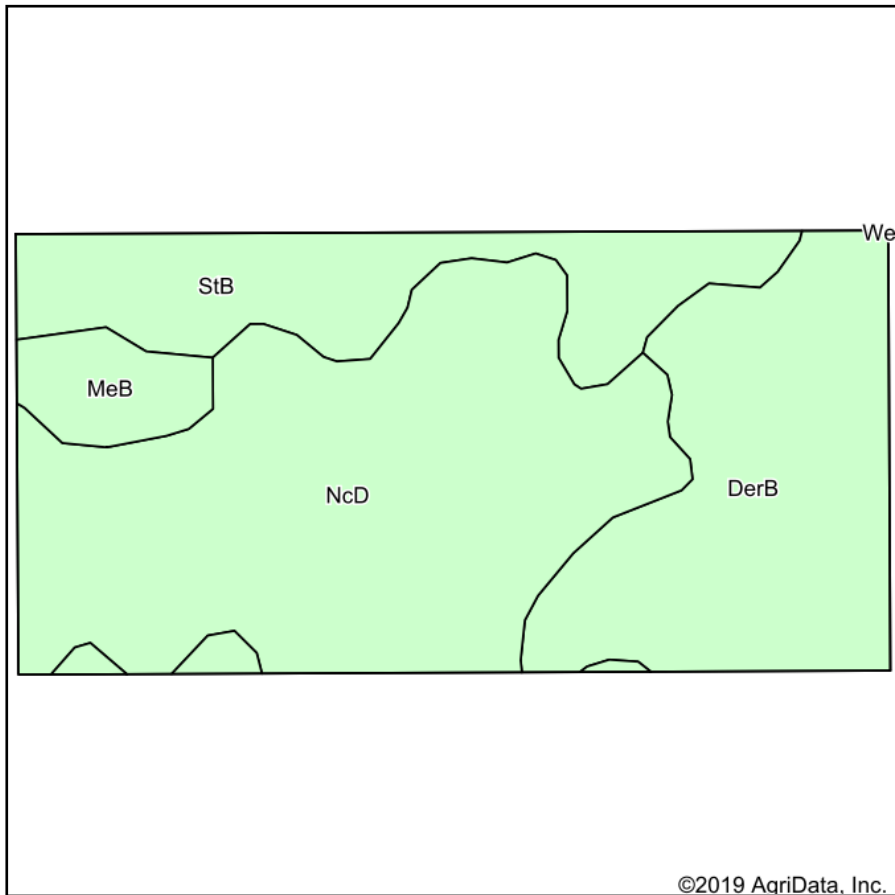

Soils data provided by USDA and NRCS.

Area Symbol: OK093, Soil Area Version: 14

Code	Soil Description	Acres	Percent of field	Water Table	Non-Irr Class *c	Irr Class *c	Range Production (lbs/acre/yr)	Introduced bluestem	Improved bermudagrass	Weeping lovegrass	Wheat	Wheat Irrigated	Small grains grazeout	Corn	Grain sorghum	Grain sorghum Irrigated
NcD	Nobscot sand, 5 to 20 percent slopes	38.46	48.2%	> 6.5ft.	Vle		3803		4	5	15	2	2			24
DerB	Derby loamy fine sand, 0 to 3 percent slopes	22.52	28.2%	> 6.5ft.	IIle		3974	3	4		15			2	3	
StB	Lovedale fine sandy loam, 1 to 3 percent slopes	14.20	17.8%	> 6.5ft.	Ile		3250	5	6	6	28					42
MeB	Meno loamy fine sand, 0 to 3 percent slopes	4.55	5.7%	2ft.	IIle		2800		5		25					30
Weighted Average							3695.6	1.7	4.4	3.5	17.9	1	1	0.6	21.6	1

*n: The aggregation method is "Weighted Average using major components"

*c: Using Capabilities Class Dominant Condition Aggregation Method

Soils data provided by USDA and NRCS.