

Soils Map

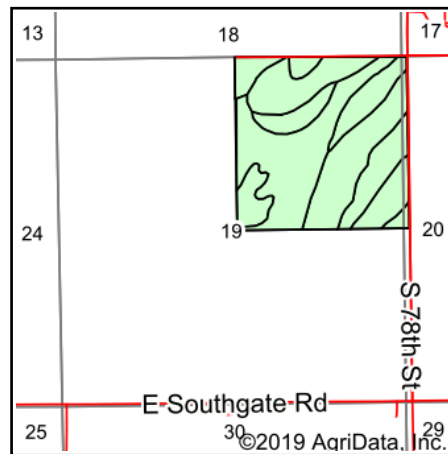

State: **Oklahoma**
 County: **Garfield**
 Location: **19-22N-5W**
 Township: **Enid**
 Acres: **159.44**
 Date: **1/28/2020**

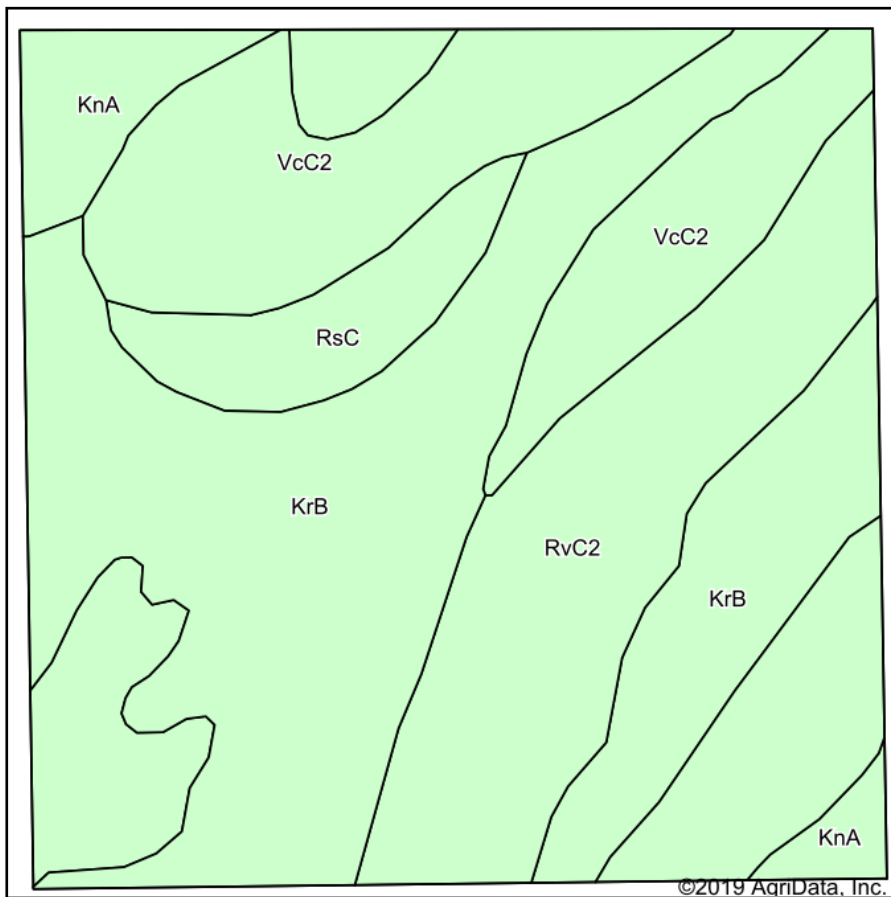

Soils data provided by USDA and NRCS.

Area Symbol: OK047, Soil Area Version: 16

| Code | Soil Description | Acres | Percent of field | Non-Irr Class *c | Irr Class *c | Range Production (lbs/acre/yr) | Cotton lint | Grain sorghum | Improved bermudagrass | Introduced bluestem | Wheat | Sorghum hay | Wheat grazeout | Oats | Barley | Weeping lovegrass | |
|-------------------------|--|-------|------------------|------------------|--------------|--------------------------------|--------------|---------------|-----------------------|---------------------|------------|-------------|----------------|------------|------------|-------------------|------------|
| KrB | Kirkland-Renfrow complex, 1 to 3 percent slopes | 64.18 | 40.3% | IIIe | | 3901 | 238 | 32 | | 4 | 28 | | | 2 | 12 | | |
| RvC2 | Renthin-Masham complex, 3 to 5 percent slopes, eroded | 47.75 | 29.9% | IIIe | | 237 | 15 | 17 | | 4 | 16 | | | 18 | 15 | | |
| VcC2 | Grainola-Masham complex, 3 to 5 percent slopes, eroded | 31.57 | 19.8% | IVe | | 0 | | | | 2 | 1 | 2 | | | | 2 | |
| RsC | Piedmont silt loam, 3 to 5 percent slopes | 8.41 | 5.3% | IIIe | | 4003 | 15 | 4 | | 4 | 21 | | | 32 | 26 | | |
| KnA | Kirkland silt loam, 0 to 1 percent slopes, cool | 7.53 | 4.7% | IIIs | IIIs | 3890 | 22 | 35 | | 4 | 5 | 34 | 5 | 4 | 34 | 4 | |
| Weighted Average | | | | | | 2036.1 | 102.1 | 19.8 | | 3.6 | 0.4 | 19.2 | 0.2 | 0.2 | 9.5 | 11.3 | 1.1 |

*n: The aggregation method is "Weighted Average using major components"

*c: Using Capabilities Class Dominant Condition Aggregation Method

Soils data provided by USDA and NRCS.