



401 W. Owen K. Garriott
PO Box 1760

Enid, Oklahoma 73702
0

*New
Map*

October 17, 2012

Re: Flood Insurance Rate Map Information

To: Henry Theilen
4613 Chisholm Creek
Enid, OK 73701

The property located at **4613 Chisholm Creek**, also known as **Lot 2, Block 5, Chisholm Creek Village; NW/4 29-23-6**, has been located on the City's Flood Insurance Rate Map (FIRM). The following information is provided:

Enid's community number: **400062**.

The property is located on panel number: **0205, Suffix E**.

Date of the FIRM Index: **June 19, 2012**.

The property is located in FIRM zone: **X & AE**

The **main building** on the property:

 is located in a Special Flood Hazard Area. The base flood elevation at the property is (NAVD 88). Federal law requires that a flood insurance policy be obtained as a condition of federally backed mortgage or loan that is secured by the building. It is up to the lender to determine whether flood insurance is required for a property. Flood insurance is available in Enid.

 X is not located in a Special Flood Hazard Area. However, the property may still be subject to local drainage problems or other unmapped flood hazard. Flood insurance is available and may be obtained at non-floodplain rates. A flood insurance policy may be required by a lender.

 A determination of the building's exact location cannot be made on the FIRM. A copy of the FIRM is attached for your information.

NOTE: This information is based on the Flood Insurance Rate Map for the City. This letter does not imply that the referenced property will or will not be free from flood damage. A property not in a Special Flood Hazard Area may be damaged by a flood greater than that predicted on the FIRM or from a local drainage problem not shown on the map. This letter does not create liability on the part of the City, or any officer or employee thereof, for any damages that result from reliance on this information.

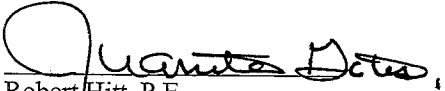
Sar.  *CFM*
Robert Hitt, P.E.
Director of Engineering Services
Floodplain Administrator



MAP SCALE 1" = 1000'



PANEL 0205E

FIRM FLOOD INSURANCE RATE MAP GARFIELD COUNTY, OKLAHOMA AND INCORPORATED AREAS

PANEL 205 OF 600

(SEE MAP INDEX FOR FIRM PANEL LAYOUT)

CONTAINS:

COMMUNITY	NUMBER	PANEL	SUFFIX
GARFIELD COUNTY	400473	0205	E
ENID, CITY OF	400062	0205	E
NORTH ENID, TOWN OF	400425	0205	E

Notice to User: The Map Number shown below should be used when placing map orders; the Community Number shown above should be used on insurance applications for the subject community.



MAP NUMBER
4004730205E
MAP REVISED
JUNE 19, 2012

Federal Emergency Management Agency

NATIONAL FLOOD INSURANCE PROGRAM

This is an official copy of a portion of the above referenced flood map. It was extracted using F-MIT On-Line. This map does not reflect changes or amendments which may have been made subsequent to the date on the title block. For the latest product information about National Flood Insurance Program flood maps check the FEMA Flood Map Store at www.msc.fema.gov

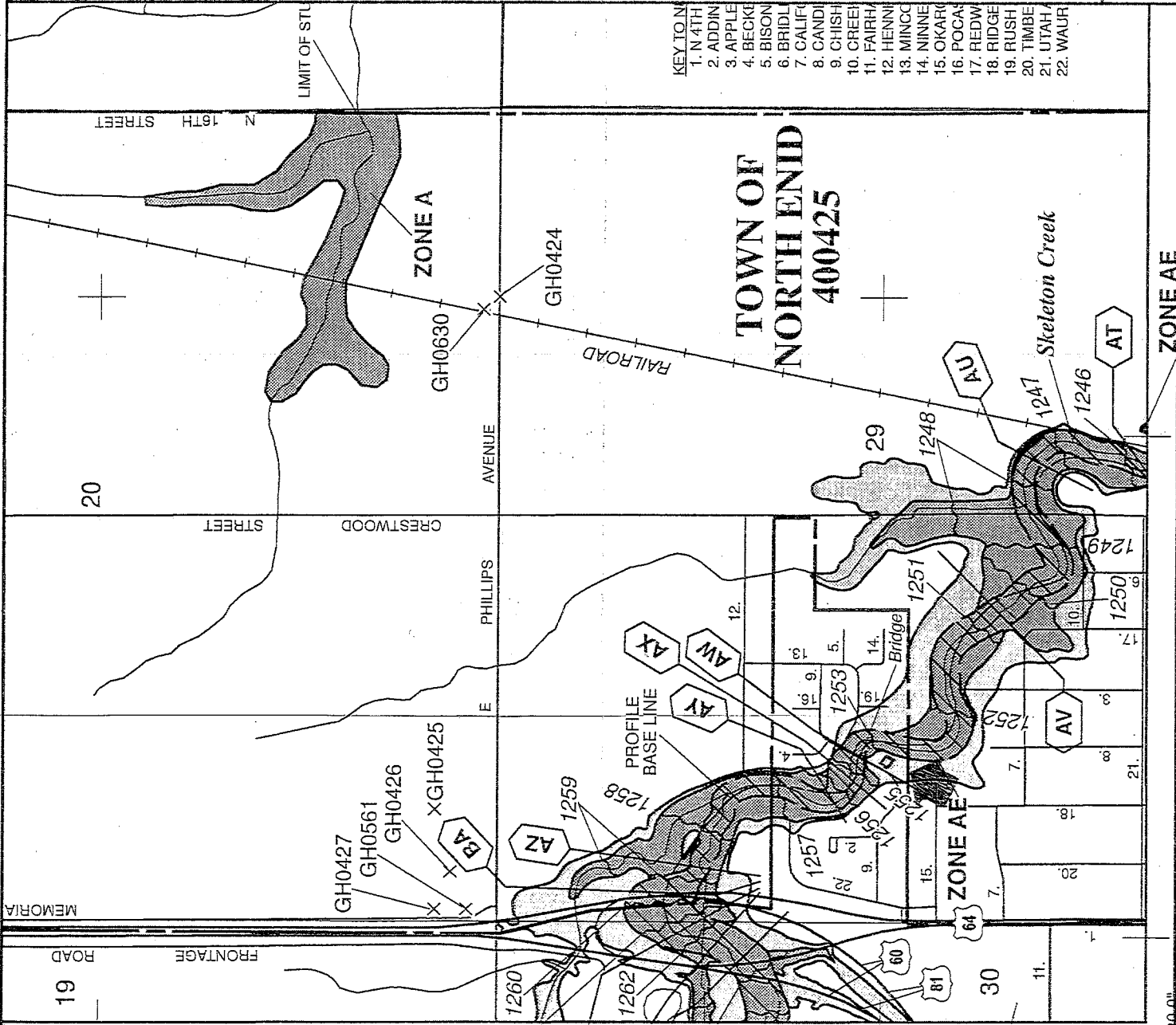

- KEY TO ZONES
1. N 4TH
 2. ADDIN
 3. APPLE
 4. BECKE
 5. BISON
 6. BRIDL
 7. CALIF
 8. CANDI
 9. CHISH
 10. CREEK
 11. FAIRH
 12. HENNI
 13. MINCC
 14. NINNE
 15. OKARK
 16. POCAK
 17. REDW
 18. RIDGE
 19. RUSH
 20. TIMBE
 21. UTAH
 22. WAUR

4613 Chisholm Creek



Address Candidates	DFIRM Cross-Sections	100 Year (A)
	—	
Parcels	DFIRM Streams	500 Year
	—	
End Contours (2010 - 1ft)	Floodway	Railroads
— Index Contours		—
— Intermediate Contours	100 Year (AE)	
DFIRM BFE		