

Soils Map

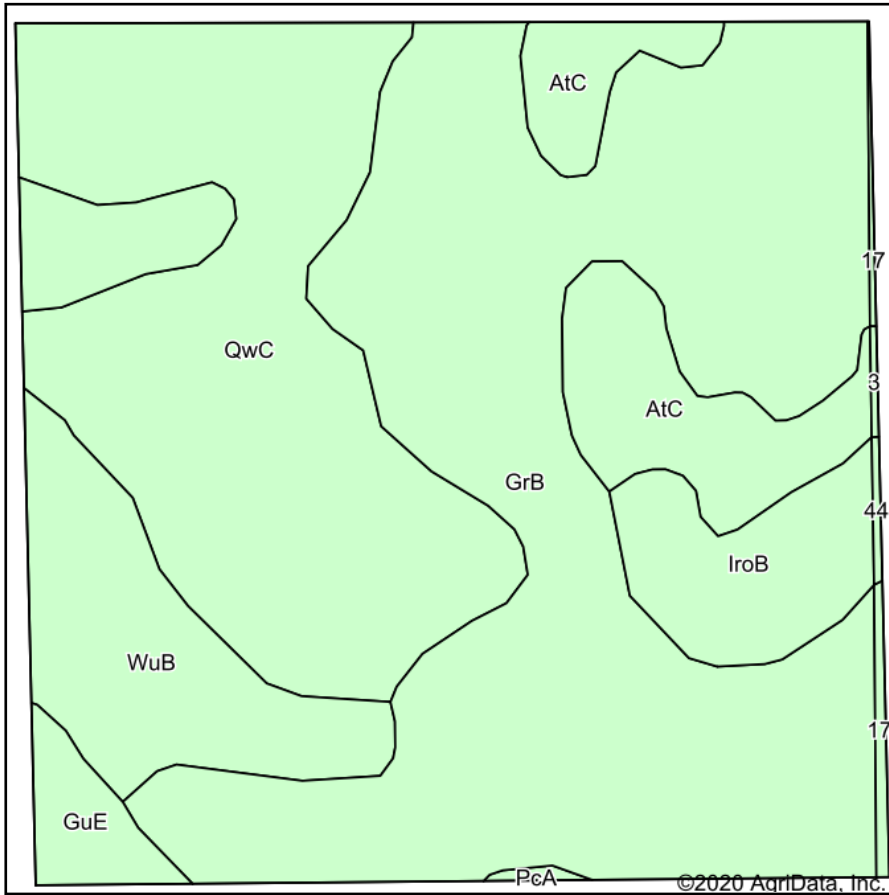

Soils data provided by USDA and NRCS.

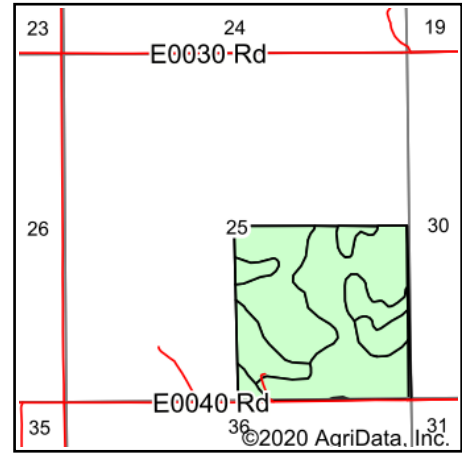

State: **Oklahoma**
 County: **Alfalfa**
 Location: **25-29N-9W**
 Township: **North Alfalfa**
 Acres: **159.51**
 Date: **8/4/2020**



Maps Provided By:



Area Symbol: OK003, Soil Area Version: 19

Area Symbol: OK053, Soil Area Version: 17

Code	Soil Description	Acres	Percent of field	Non-Irr Class *c	Irr Class *c	Range Production (lbs/acre/yr)	Alfalfa hay	Barley	Cantaloupe	Caucasian bluestem	Cotton lint	Cotton lint Irrigated	Grain sorghum	Grain sorghum Irrigated	Improved bermudagrass	Intro bluestem
GrB	Grant silt loam, 1 to 3 percent slopes	73.05	45.8%	Ile		4579	2	1	5		8		48			6
QwC	Quinlan-Woodward complex, 3 to 5 percent slopes	42.96	26.9%	IVe		3055		12			100		22			3
WuB	Woodward-Quinlan complex, 1 to 3 percent slopes	18.13	11.4%	IIIs		3308		10			168		29			4
AtC	Devol fine sandy loam, 3 to 5 percent slopes	12.31	7.7%	IIle	IIle	2794	4				18	30	29	3		5
IroB	Ironmound loam, 1 to 3 percent slopes	8.30	5.2%	IVs		3277							1			3
GuE	Grant-Port, frequently flooded, complex, 0 to 12 percent slopes	3.18	2.0%	VIe		5064	1	2		3	44		30			5



17	Grant silt loam, 1 to 3 percent slopes	0.94	0.6%	Ile		4579	2	1	5	8	48	6			
44	Ironmound loam, 1 to 3 percent slopes	0.25	0.2%	IVs		3277					1	3			
PcA	Pond Creek silt loam, 0 to 1 percent slopes	0.23	0.1%	le	le	4747	4			58	50	5			
3	Devol fine sandy loam, 3 to 5 percent slopes	0.16	0.1%	Ille		3253				225	30	5			
Weighted Average						3825.1	1.3	4.9	2.3	0.1	52.3	2.3	34.5	0.2	4.7

*n: The aggregation method is "Weighted Average using all components"

*c: Using Capabilities Class Dominant Condition Aggregation Method

Soils data provided by USDA and NRCS.