

Soils Map

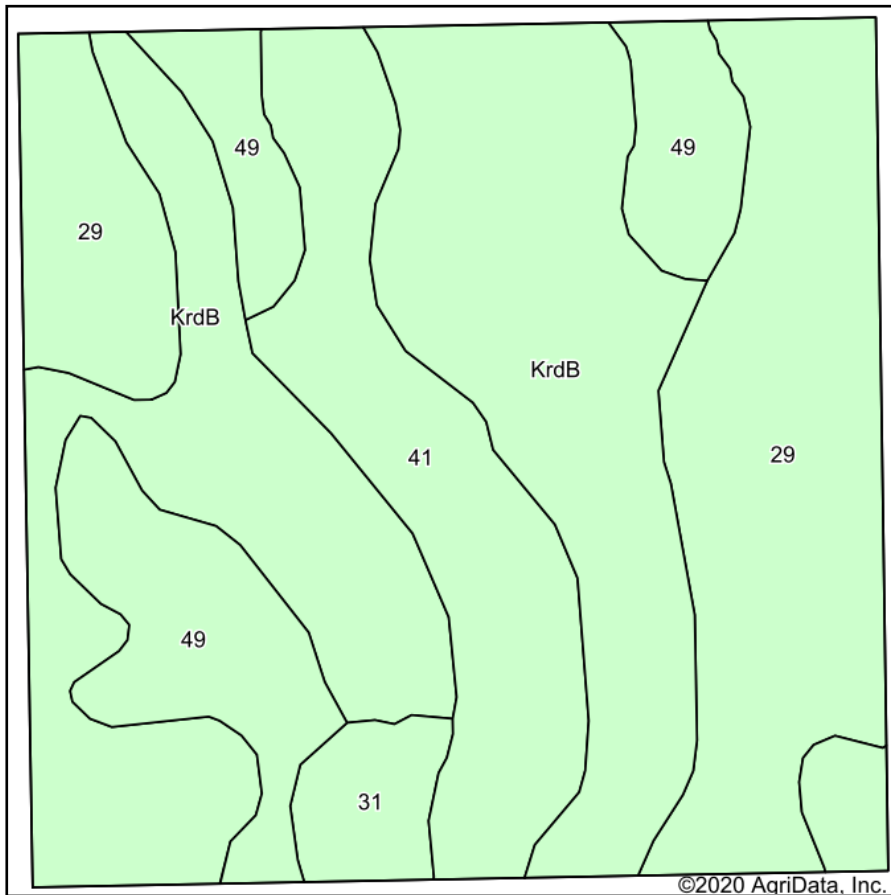

Soils data provided by USDA and NRCS.

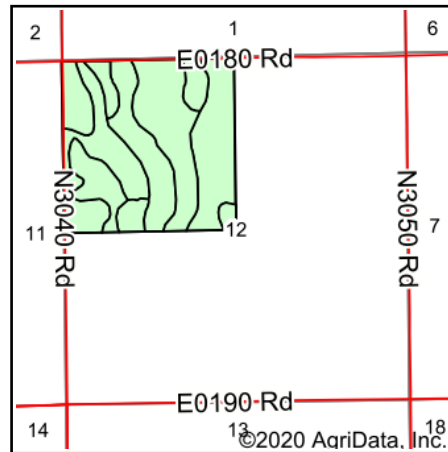

State: **Oklahoma**
 County: **Grant**
 Location: **12-26N-4W**
 Township: **Lamont**
 Acres: **160.36**
 Date: **8/19/2020**



Maps Provided By:



Area Symbol: OK053, Soil Area Version: 17

Code	Soil Description	Acres	Percent of field	Non-Irr Class *c	Irr Class *c	Range Production (lbs/acre/yr)	Alfalfa hay	Barley	Caucasian bluestem	Cotton lint	Grain sorghum	Improved bermudagrass	Introduced bluestem	Oats	Peanuts	Sorghum hay
KrdB	Kirkland silt loam, 1 to 3 percent slopes	66.66	41.6%	Ils	Ils	3926		2		50	34	4	5	32		5
29	Kirkland silt loam, 0 to 1 percent slopes, cool	42.29	26.4%	Ils	Ils	3890		4		22	35	4	5	34		5
41	Port silt loam, 0 to 1 percent slopes, occasionally flooded	23.70	14.8%	IIw		6112	5			13	49	9			48	
49	Renfrow silty clay loam, 3 to 5 percent slopes, eroded	22.97	14.3%	IVe		0						3				
31	Kirkland-Pawhuska complex, 0 to 3 percent slopes	4.74	3.0%	Ils	Ils	3673		2	1	51	27	4	4	23		3
Weighted Average						3669.7	0.7	1.9	*-	30	31.4	4.6	3.5	22.9	7.1	3.5

*n: The aggregation method is "Weighted Average using all components"

*c: Using Capabilities Class Dominant Condition Aggregation Method

Soils data provided by USDA and NRCS.