

Soils Map

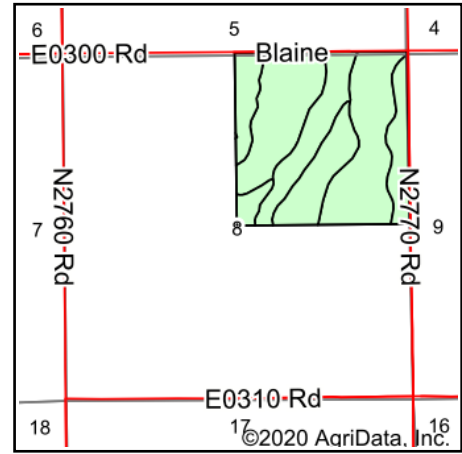

State: **Oklahoma**
 County: **Garfield**
 Location: **8-24N-8W**
 Township: **North Garfield**
 Acres: **159.69**
 Date: **12/16/2020**

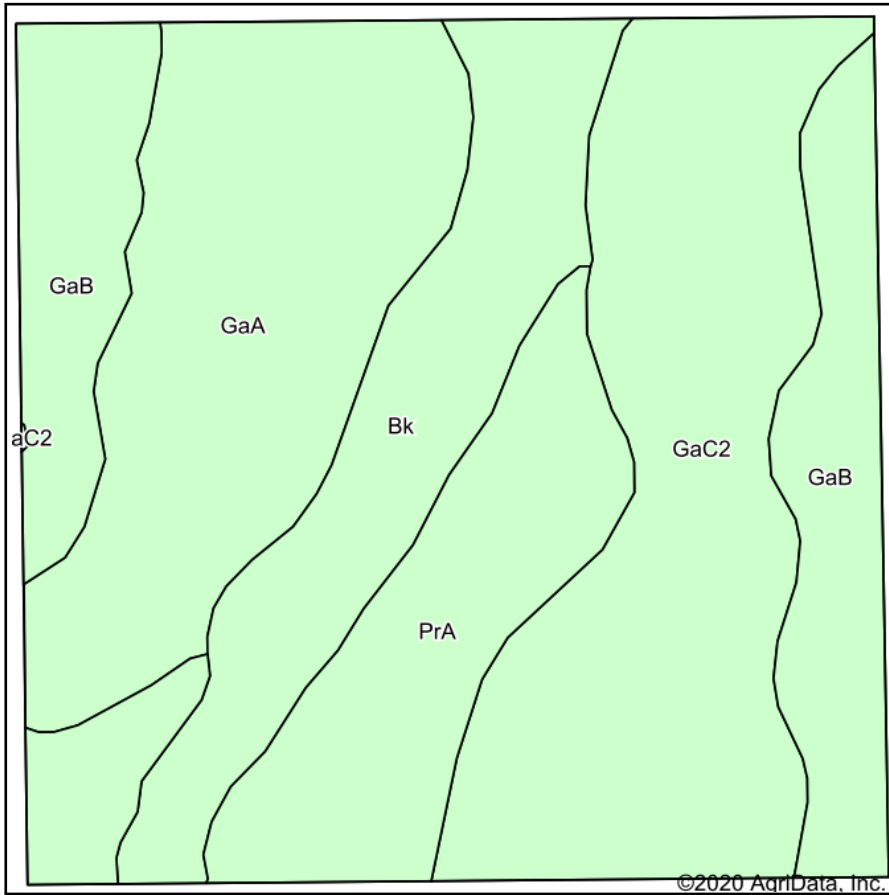

Maps Provided By:



© AgriData, Inc. 2020

www.AgriDataInc.com



Soils data provided by USDA and NRCS.

Code	Soil Description	Acres	Percent of field	Non-Irr Class *c	Range Production (lbs/acre/yr)	Alfalfa hay	Barley	Caucasian bluestem	Cotton lint	Grain sorghum	Improved bermudagrass	Introduced bluestem	Peanuts	Small grains grazeout	Weep loveg
GaC2	Grant silt loam, 3 to 5 percent slopes, eroded	45.07	28.2%	IIIe	0				5	248	30	5	4		3
GaA	Pond Creek silt loam, 0 to 1 percent slopes, deep	37.79	23.7%	Ie	4705	4	42			435	49	6	5		
GaB	Grant silt loam, 1 to 3 percent slopes, shallow	31.65	19.8%	Ile	4705	2	2			346	48	6	5		
Bk	Grainola, Ashport frequently flooded, and Grant soils, 0 to 20 percent slopes	23.90	15.0%	VIe	4629							5	1		
PrA	Port silt loam, 0 to 1 percent slopes, occasionally flooded	21.28	13.3%	IIw	6112	5			13	49	9		48		
Weighted Average					3553.2	2	10.3	1.4	243.2	36.1	6	3.5	6.4	0.8	

*n: The aggregation method is "Weighted Average using all components"

*c: Using Capabilities Class Dominant Condition Aggregation Method

Soils data provided by USDA and NRCS.