

# Soils Map

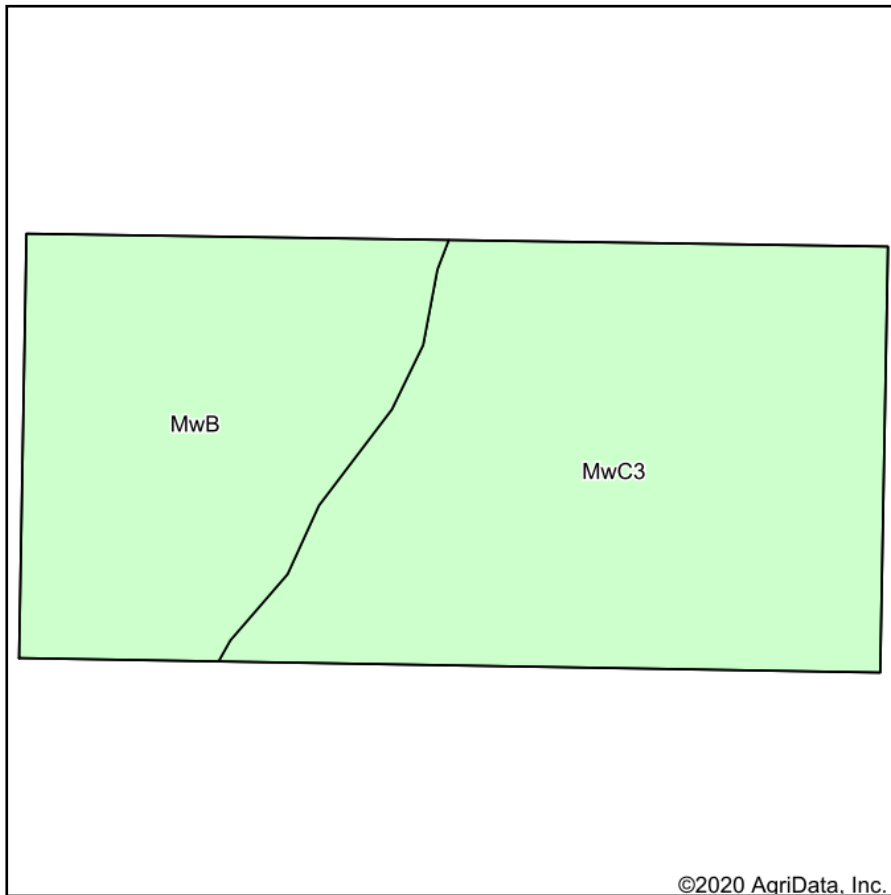

Soils data provided by USDA and NRCS.

©2020 AgriData, Inc.

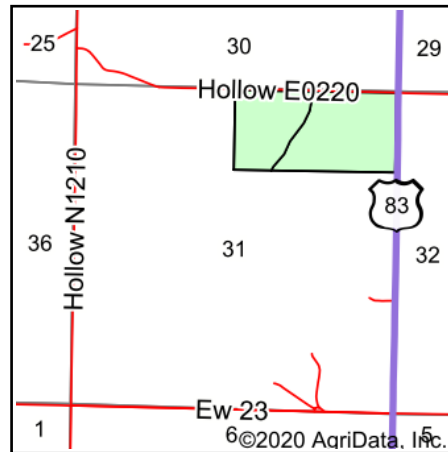

State: **Oklahoma**  
 County: **Beaver**  
 Location: **31-3N-21E**  
 Township: **South Beaver**  
 Acres: **80.15**  
 Date: **12/9/2020**



Maps Provided By:



© AgriData, Inc. 2020

www.AgriDataInc.com



| Code                    | Soil Description                                       | Acres | Percent of field | Non-Irr Class *c | Irr Class *c | Range Production (lbs/acre/yr) | Alfalfa hay Irrigated | Corn Irrigated | Grain sorghum | Grain sorghum Irrigated | Introduced bluestem | Sorghum hay | Wheat       | Wheat Irrigated | *n NCCPI Overall | *n NCC Corn |
|-------------------------|--|-------|------------------|------------------|--------------|--------------------------------|-----------------------|----------------|---------------|-------------------------|---------------------|-------------|-------------|-----------------|------------------|-------------|
| MwC3                    | Mansic-Woodward complex, 3 to 5 percent slopes, eroded | 49.51 | 61.8%            | IIIe             |              | 75                             |                       |                | 2             |                         | 2                   |             | 17          |                 | 46               |             |
| MwB                     | Mansic-Woodward complex, 1 to 3 percent slopes         | 30.64 | 38.2%            | IIIe             | IIIe         | 2738                           | 4                     | 65             | 26            | 69                      | 3                   | 3           | 20          | 38              | 55               |             |
| <b>Weighted Average</b> |  |       |                  |                  |              | <b>1093</b>                    | <b>1.5</b>            | <b>24.8</b>    | <b>11.2</b>   | <b>26.4</b>             | <b>2.4</b>          | <b>1.1</b>  | <b>18.1</b> | <b>14.5</b>     | <b>*n 49.4</b>   | <b>*n 2</b> |

\*n: The aggregation method is "Weighted Average using all components"

\*c: Using Capabilities Class Dominant Condition Aggregation Method

Soils data provided by USDA and NRCS.