

Soils Map

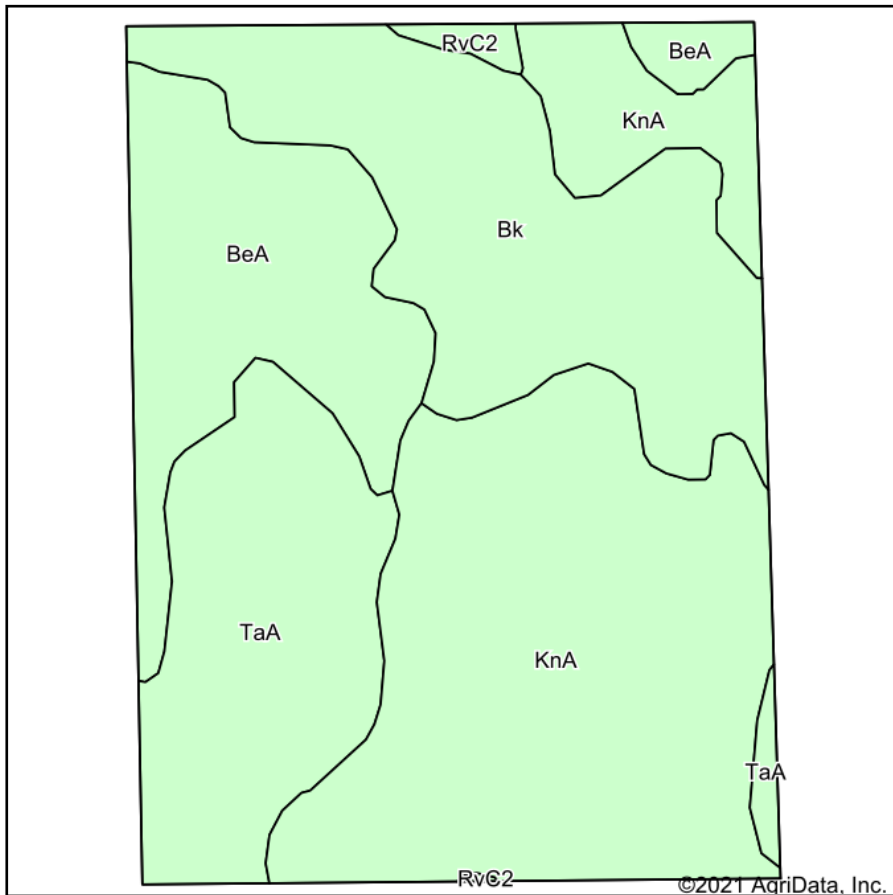

Soils data provided by USDA and NRCS.

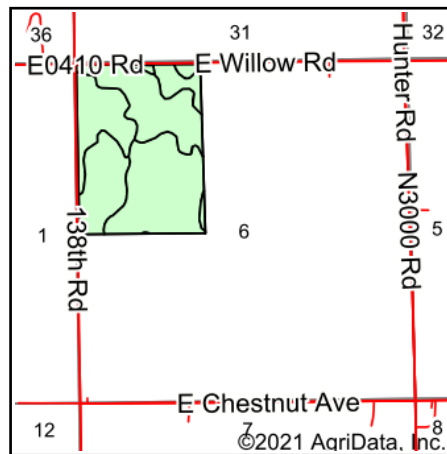

State: **Oklahoma**
 County: **Garfield**
 Location: **6-22N-4W**
 Township: **Enid**
 Acres: **117.16**
 Date: **1/7/2021**



Maps Provided By:



Code	Soil Description	Acres	Percent of field	Water Table	Non-Irr Class *c	Irr Class *c	Range Production (lbs/acre/yr)	Barley	Cotton lint	Grain sorghum	Improved bermudagrass	Introduced bluestem	Oats	Sorghum hay	Tall fescue	Weeping lovegrass
KnA	Kirkland silt loam, 0 to 1 percent slopes, cool	46.84	40.0%	> 6.5ft.	Ils	Ils	3890	4	22	35	4	5	34	5		
Bk	Grainola, Ashport frequently flooded, and Grant soils, 0 to 20 percent slopes	27.56	23.5%	> 6.5ft.	Vle		4629				5	1				
TaA	Tabler silt loam, 0 to 1 percent slopes	21.15	18.1%	0.7ft.	Ils		3918	41	17	49	4		3		5	
BeA	Bethany silt loam, 0 to 1 percent slopes	20.77	17.7%	> 6.5ft.	Ils	Ile	4633	2	276	44	5	5	2			
RvC2	Renthin-Masham complex, 3 to 5 percent slopes, eroded	0.84	0.7%	> 6.5ft.	Ile		237	15	15	17	4		18			
Weighted Average							4174.4	9.5	60.9	30.8	4.4	3.1	14.6	2	0.9	0

*n: The aggregation method is "Weighted Average using all components"

*c: Using Capabilities Class Dominant Condition Aggregation Method

Soils data provided by USDA and NRCS.