

Soils Map

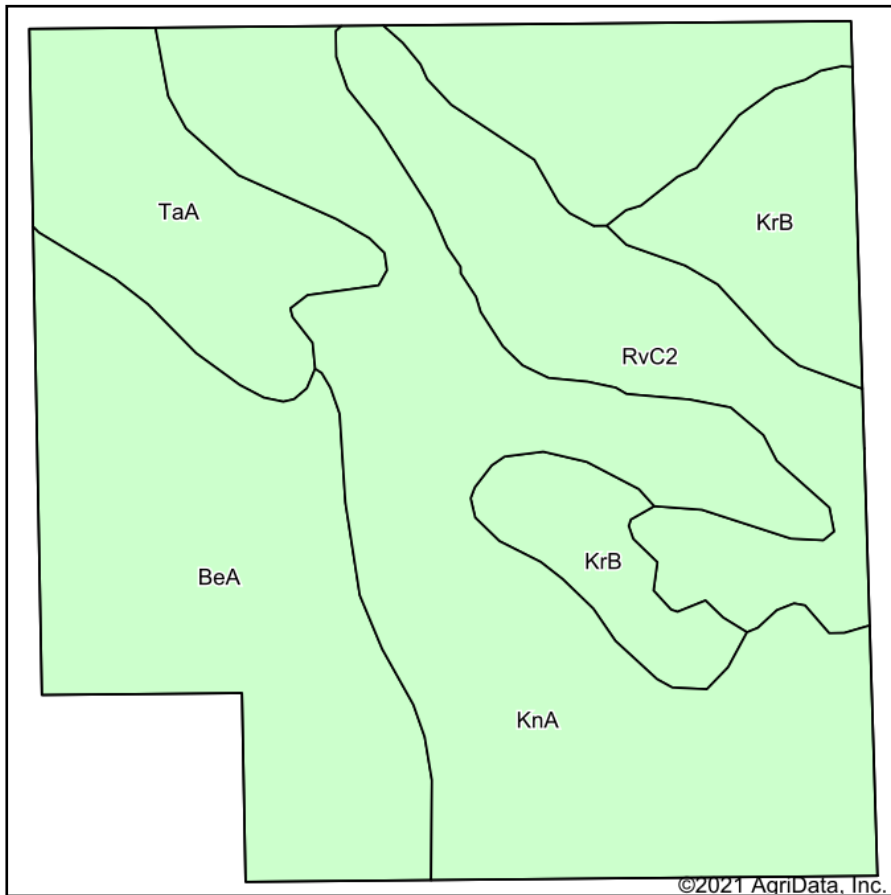

Soils data provided by USDA and NRCS.

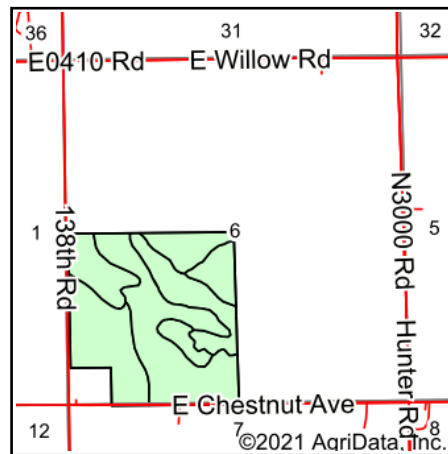

State: **Oklahoma**
 County: **Garfield**
 Location: **6-22N-4W**
 Township: **Enid**
 Acres: **146.46**
 Date: **1/7/2021**



Maps Provided By:



Code	Soil Description	Acres	Percent of field	Water Table	Non-Irr Class *c	Irr Class *c	Range Production (lbs/acre/yr)	Barley	Cotton lint	Grain sorghum	Improved bermudagrass	Introduced bluestem	Oats	Sorghum hay	Tall fescue	Weeping lovegrass
KnA	Kirkland silt loam, 0 to 1 percent slopes, cool	62.92	43.0%	> 6.5ft.	IIs	IIs	3890	4	22	35	4	5	34	5		
BeA	Bethany silt loam, 0 to 1 percent slopes	32.64	22.3%	> 6.5ft.	IIs	Ile	4633	2	276	44	5	5	2			
RvC2	Renthin-Masham complex, 3 to 5 percent slopes, eroded	20.68	14.1%	> 6.5ft.	IIle		237	15	15	17	4		18			
KrB	Kirkland-Renfrow complex, 1 to 3 percent slopes	15.57	10.6%	> 6.5ft.	IIle		3901	12	238	32	4		2			
TaA	Tabler silt loam, 0 to 1 percent slopes	14.65	10.0%	0.7ft.	IIs		3918	41	17	49	4		3		5	
Weighted Average							3543.8	9.7	100.1	35.5	4.2	3.3	18.1	2.1	0.5	0

*n: The aggregation method is "Weighted Average using all components"

*c: Using Capabilities Class Dominant Condition Aggregation Method

Soils data provided by USDA and NRCS.