

Soils Map

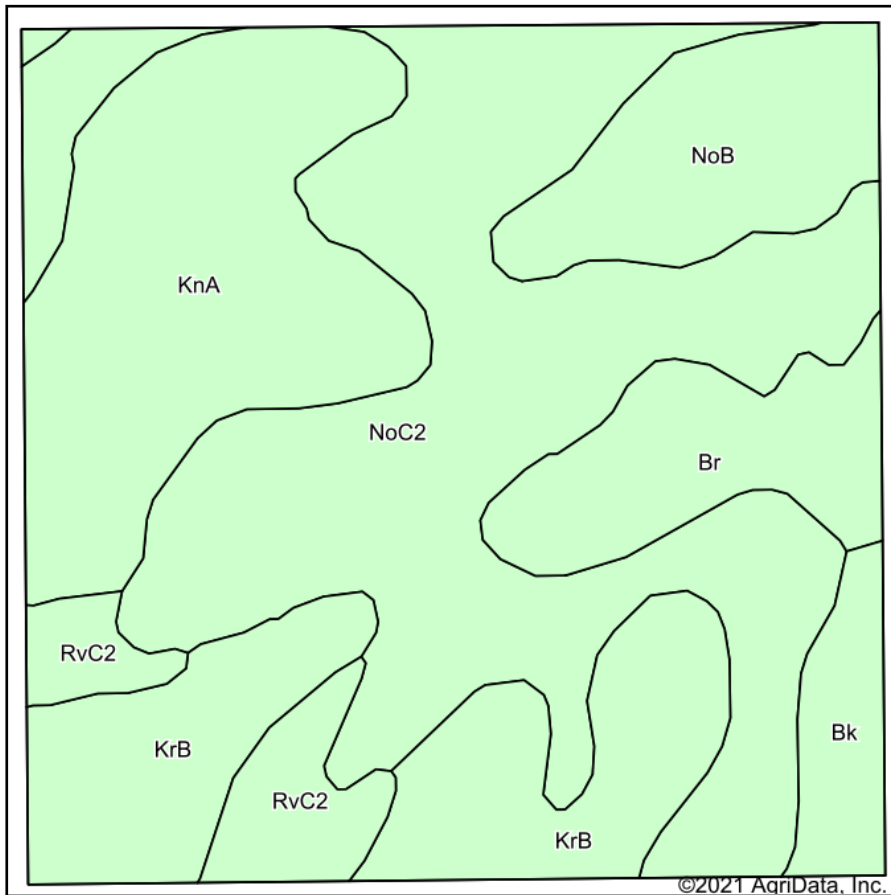

Soils data provided by USDA and NRCS.

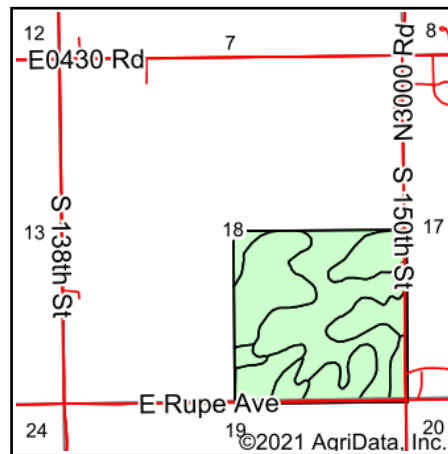

State: **Oklahoma**
 County: **Garfield**
 Location: **18-22N-4W**
 Township: **Enid**
 Acres: **159.47**
 Date: **1/7/2021**



Maps Provided By:



Code	Soil Description	Acres	Percent of field	Non-Irr Class *c	Irr Class *c	Range Production (lbs/acre/yr)	Alfalfa hay	Barley	Caucasian bluestem	Cotton lint	Grain sorghum	Improved bermudagrass	Introduced bluestem	Oats	Peanuts	Sorghum
NoC2	Norge loam, 3 to 5 percent slopes, eroded	64.54	40.5%	IIIe		0										
KnA	Kirkland silt loam, 0 to 1 percent slopes, cool	30.92	19.4%	IIIs	IIIs	3890		4		22	35	4	5	34		
KrB	Kirkland-Renfrow complex, 1 to 3 percent slopes	24.81	15.6%	IIIe		3901		12		238	32	4		2		
NoB	Norge loam, 1 to 3 percent slopes	13.65	8.6%	IIe		4705	3	2		360	49	6	5		75	
Br	Pulaski and Ashport soils, 0 to 1 percent slopes, frequently flooded	12.38	7.8%	Vw		6445			1			8	1			
RvC2	Renthin-Masham complex, 3 to 5 percent slopes, eroded	7.77	4.9%	IIIe		237		15		15	17	4		18		



Bk	Grainola, Ashport frequently flooded, and Grant soils, 0 to 20 percent slopes	5.40	3.4%	Vle		4629						5	1		
Weighted Average						2432.5	0.3	3.5	0.1	72.8	16.8	2.9	1.5	7.8	6.4

*n: The aggregation method is "Weighted Average using all components"

*c: Using Capabilities Class Dominant Condition Aggregation Method
Soils data provided by USDA and NRCS.