

# Soils Map

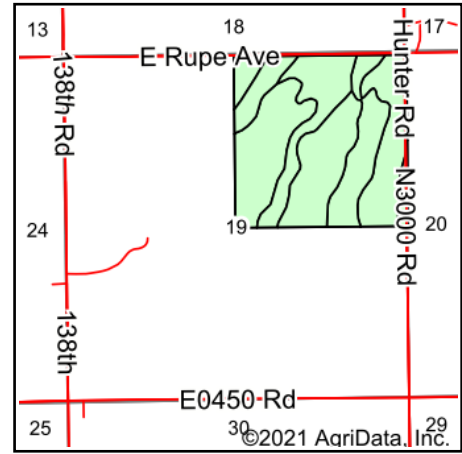

State: **Oklahoma**  
 County: **Garfield**  
 Location: **19-22N-4W**  
 Township: **Enid**  
 Acres: **158.71**  
 Date: **1/7/2021**

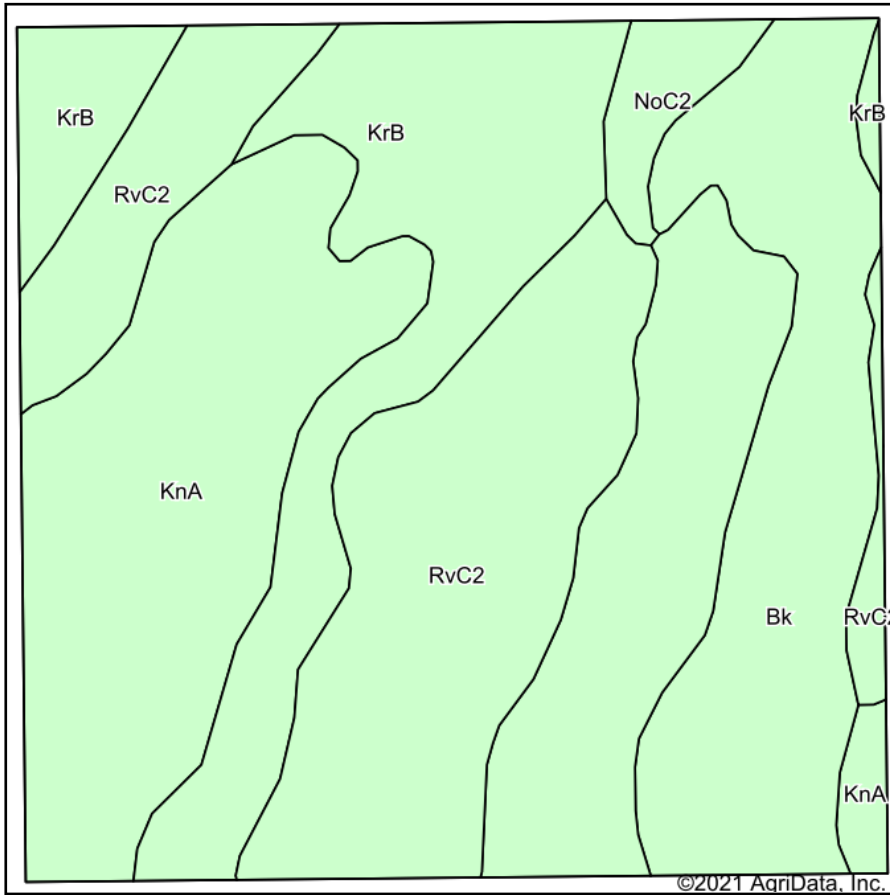

Maps Provided By:



Soils data provided by USDA and NRCS.

Code	Soil Description	Acres	Percent of field	Non-Irr Class *c	Irr Class *c	Range Production (lbs/acre/yr)	Barley	Cotton lint	Grain sorghum	Improved bermudagrass	Introduced bluestem	Oats	Sorghum hay	Weeping lovegrass	Wheat	Wheat grazing
KnA	Kirkland silt loam, 0 to 1 percent slopes, cool	55.78	35.1%	Ils	Ils	3890	4	22	35	4	5	34	5		34	
RvC2	Renthin-Masham complex, 3 to 5 percent slopes, eroded	40.64	25.6%	IIIe		237	15	15	17	4		18			16	
KrB	Kirkland-Renfrow complex, 1 to 3 percent slopes	30.80	19.4%	IIIe		3901	12	238	32	4		2		3	28	
Bk	Grainola, Ashport frequently flooded, and Grant soils, 0 to 20 percent slopes	27.86	17.6%	VIe		4629				5	1			1		
NoC2	Norge loam, 3 to 5 percent slopes, eroded	3.63	2.3%	IIIe		0										
<b>Weighted Average</b>						<b>2997.5</b>	<b>7.6</b>	<b>57.8</b>	<b>22.9</b>	<b>4.1</b>	<b>1.9</b>	<b>16.9</b>	<b>1.8</b>	<b>0.8</b>	<b>21.5</b>	

\*n: The aggregation method is "Weighted Average using all components"

\*c: Using Capabilities Class Dominant Condition Aggregation Method

Soils data provided by USDA and NRCS.