

# Soils Map

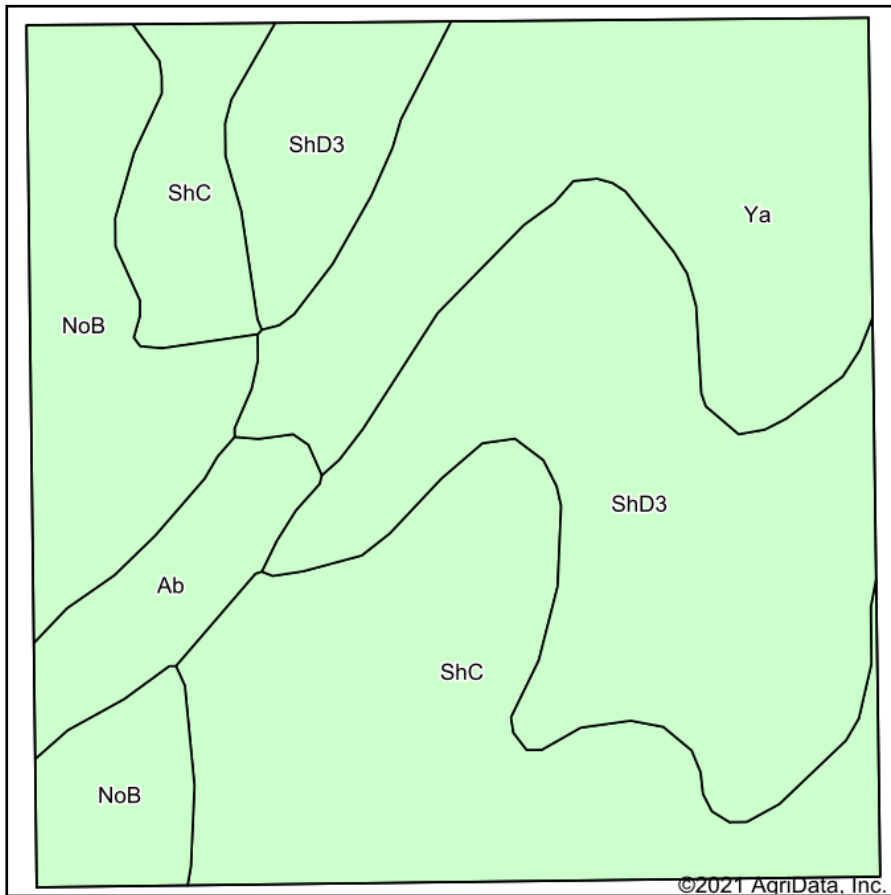

Soils data provided by USDA and NRCS.

©2021 AgriData, Inc.

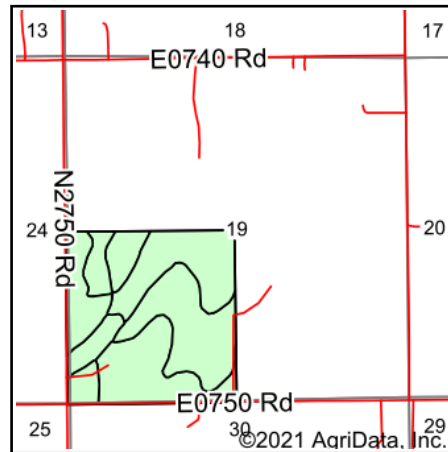

State: **Oklahoma**  
 County: **Kingfisher**  
 Location: **19-17N-8W**  
 Township: **Kingfisher**  
 Acres: **156.61**  
 Date: **3/10/2021**



Maps Provided By:



© AgriData, Inc. 2021

www.AgriDataInc.com



Area Symbol: OK073, Soil Area Version: 16

Code	Soil Description	Acres	Percent of field	Non-Irr Class *c	Irr Class *c	Range Production (lbs/acre/yr)	Alfalfa hay Irrigated	Alfalfa hay	Cantaloupe	Caucasian bluestem	Cotton lint	Grain sorghum	Grain sorghum Irrigated	Improved bermudagrass	Impr bermu Irrigat
ShD3	Lovedale fine sandy loam, 5 to 8 percent slopes, eroded	48.89	31.2%	IIIe		0						2			6
ShC	Lovedale fine sandy loam, 3 to 5 percent slopes	43.26	27.6%	IIIe		3223		3				44			6
Ya	Yahola fine sandy loam, 0 to 1 percent slopes, occasionally flooded	33.85	21.6%	IIIe		5995			227	6	383	49			7
NoB	Milan fine sandy loam, 1 to 3 percent slopes	22.77	14.5%	Ile	Ile	4597	7				16	52	102		1
Ab	Grainola-Ashport, frequently flooded, complex, 0 to 12 percent slopes	7.84	5.0%	IVe		4306									4
<b>Weighted Average</b>						<b>3070</b>	<b>1</b>	<b>0.8</b>	<b>49.1</b>	<b>1.3</b>	<b>85.1</b>	<b>30.9</b>	<b>14.8</b>		<b>5.4</b>

\*n: The aggregation method is "Weighted Average using all components"

\*c: Using Capabilities Class Dominant Condition Aggregation Method

Soils data provided by USDA and NRCS.