

Soils Map

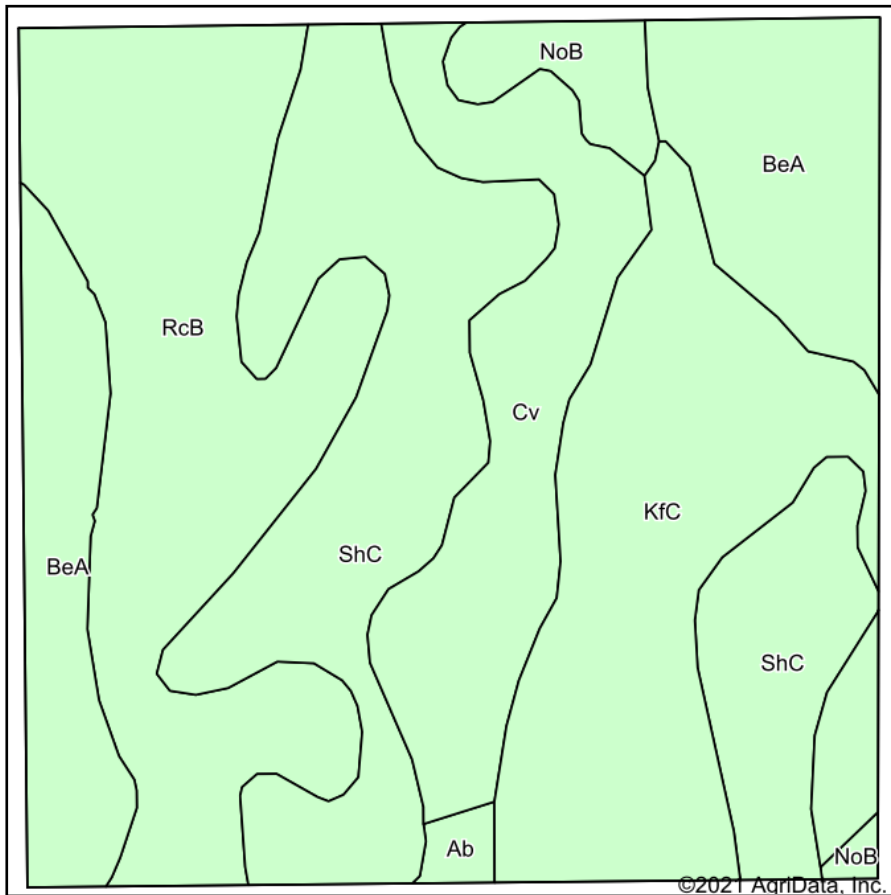

Soils data provided by USDA and NRCS.

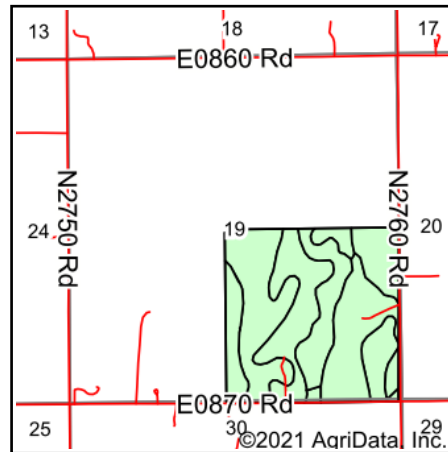

State: **Oklahoma**
 County: **Kingfisher**
 Location: **19-15N-8W**
 Township: **Okarche-Cashion**
 Acres: **161.42**
 Date: **2/23/2021**

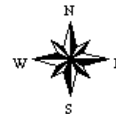

Code	Soil Description	Acres	Percent of field	Non-Irr Class *c	Irr Class *c	Range Production (lbs/acre/yr)	Alfalfa hay Irrigated	Alfalfa hay	Barley	Caucasian bluestem	Common bermudagrass	Cotton lint	Grain sorghum	Grain sorghum Irrigated	Improved bermudagrass
ShC	Lovedale fine sandy loam, 3 to 5 percent slopes	39.85	24.7%	IIIe		3223		3					44		
RcB	Renthin clay loam, 1 to 3 percent slopes	37.95	23.5%	IIIe		4028			28			34	8		
KfC	Kingfisher silt loam, 3 to 5 percent slopes	33.06	20.5%	IIIe		4705			1			8	40		
BeA	Bethany silt loam, 0 to 1 percent slopes	25.03	15.5%	IIs	IIe	4633			2			276	44		
Cv	Miller clay, saline, 0 to 1 percent slopes, occasionally flooded	19.92	12.3%	IVw		3275			28	1		4	20	5	
NoB	Milan fine sandy loam, 1 to 3 percent slopes	4.51	2.8%	IIe	IIe	4597	7					16	52	102	
Ab	Grainola-Ashport, frequently flooded, complex, 0 to 12 percent slopes	1.10	0.7%	IVe		4306									
Weighted Average						3986.6	0.2	0.7	10.6	0.1	0.5	55.3	29.8	2.8	

*n: The aggregation method is "Weighted Average using all components"

*c: Using Capabilities Class Dominant Condition Aggregation Method

Soils data provided by USDA and NRCS.