

Soils Map

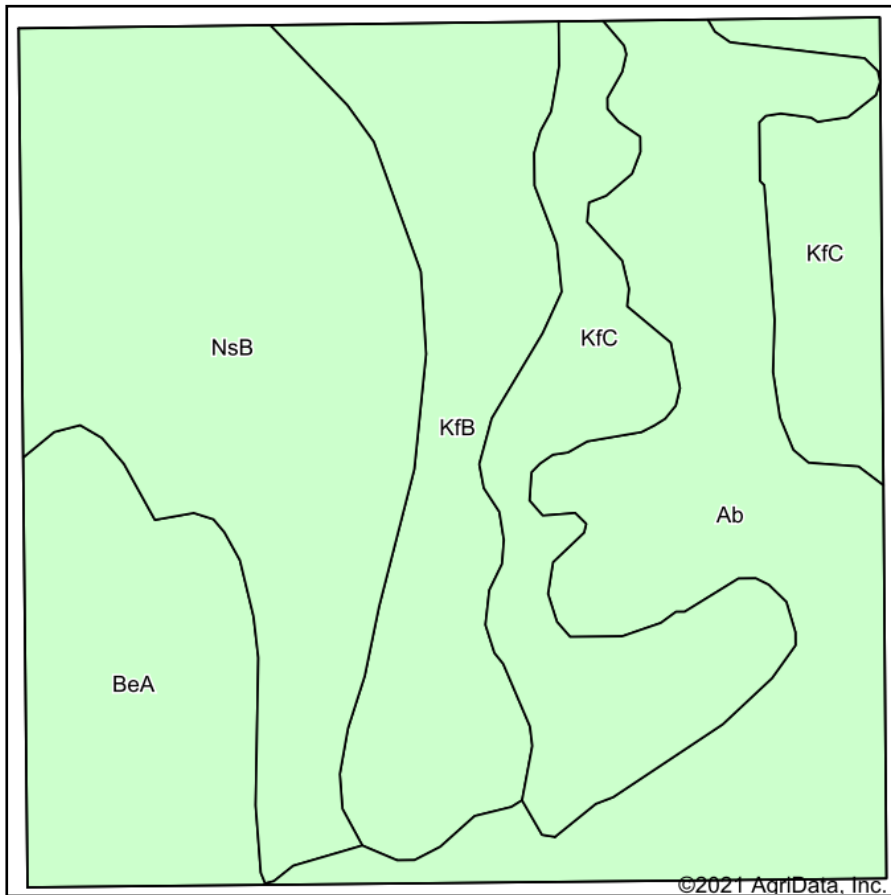

Soils data provided by USDA and NRCS.

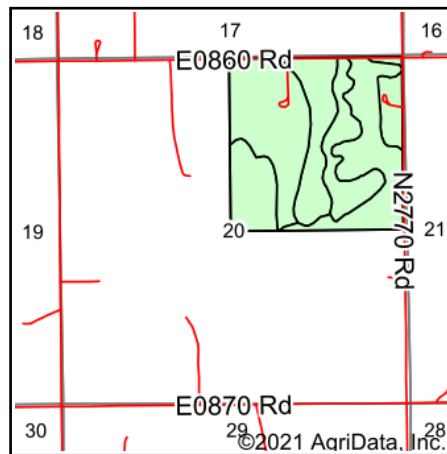

State: **Oklahoma**
 County: **Kingfisher**
 Location: **20-15N-8W**
 Township: **Okarche-Cashion**
 Acres: **160.4**
 Date: **2/23/2021**



Maps Provided By:



Code	Soil Description	Acres	Percent of field	Non-Irr Class *c	Irr Class *c	Range Production (lbs/acre/yr)	Alfalfa hay Irrigated	Barley	Cotton lint	Grain sorghum	Grain sorghum Irrigated	Improved bermudagrass	Introduced bluestem	Oats	Smooth bromegrass
NsB	Milan-Pawhuska complex, 1 to 3 percent slopes	45.95	28.6%	Ile	Ile	4263	5		16	42	81		1		4
Ab	Grainola-Ashport, frequently flooded, complex, 0 to 12 percent slopes	39.96	24.9%	IVe		4306							4	4	
KfC	Kingfisher silt loam, 3 to 5 percent slopes	29.31	18.3%	IIle		4705		1	8	40			5	5	
KfB	Kingfisher silt loam, 1 to 3 percent slopes	25.16	15.7%	IIIe		4662		2	13	40			5	5	2
BeA	Bethany silt loam, 0 to 1 percent slopes	20.02	12.5%	IIs	Ile	4633		2	276	44			5	5	2
Weighted Average						4463.2	1.4	0.7	42.5	31.1	23.2	3.6	3.3	0.6	1.1

*n: The aggregation method is "Weighted Average using all components"

*c: Using Capabilities Class Dominant Condition Aggregation Method

Soils data provided by USDA and NRCS.