

# Soils Map

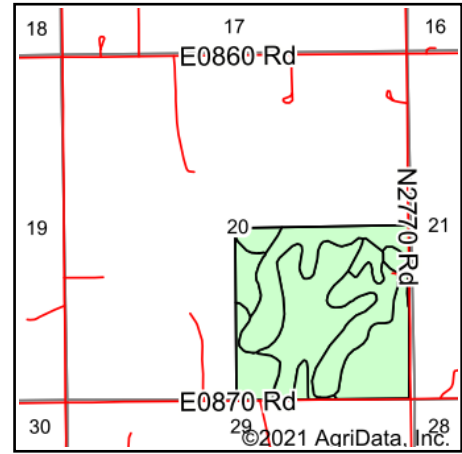

State: **Oklahoma**  
 County: **Kingfisher**  
 Location: **20-15N-8W**  
 Township: **Okarche-Cashion**  
 Acres: **160.81**  
 Date: **2/23/2021**

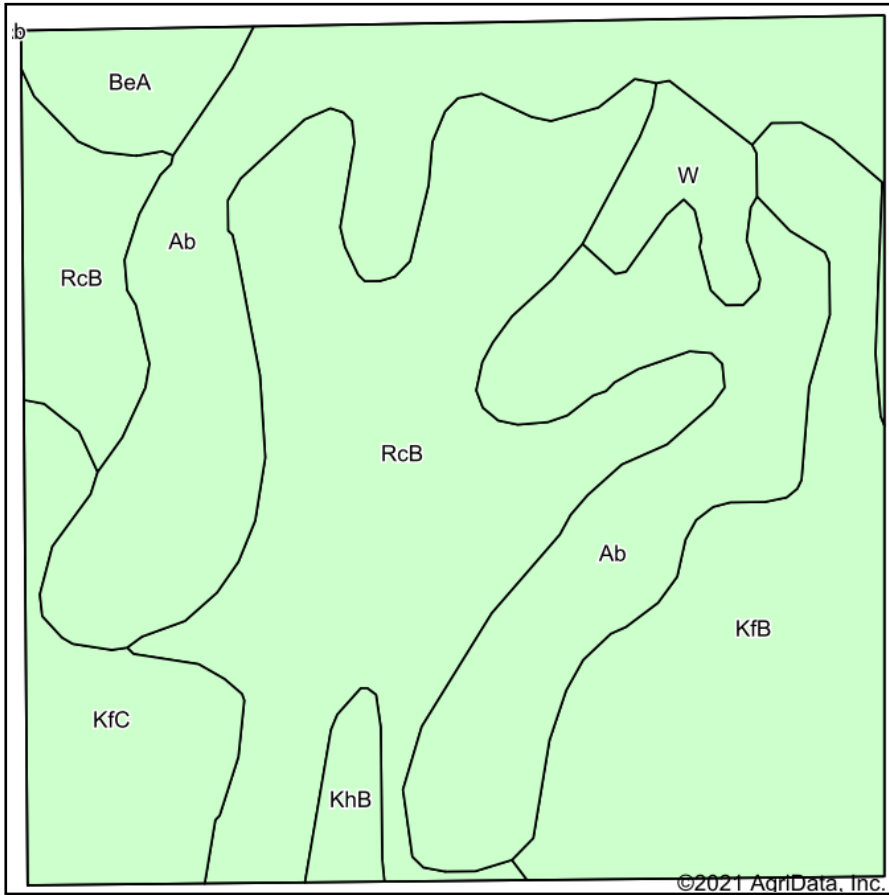

Maps Provided By:



© AgriData, Inc. 2021

www.AgriDataInc.com



Soils data provided by USDA and NRCS.

Code	Soil Description	Acres	Percent of field	Water Table	Non-Irr Class *c	Irr Class *c	Range Production (lbs/acre/yr)	Barley	Cotton lint	Grain sorghum	Improved bermudagrass	Introduced bluestem	Oats	Wheat	*n NCCPI Overall	*n NCCPI Corn	*n NCCPI Small Gr	
Ab	Grainola-Ashport, frequently flooded, complex, 0 to 12 percent slopes	54.89	34.1%	> 6.5ft.	Ive		4306					4	4		42	36		
RcB	Renthin clay loam, 1 to 3 percent slopes	51.99	32.3%	> 6.5ft.	IIle		4028	28	34	8	4	1	34	26	53	42		
KfB	Kingfisher silt loam, 1 to 3 percent slopes	30.06	18.7%	> 6.5ft.	IIle		4662	2	13	40		5	5	30	57	45		
KfC	Kingfisher silt loam, 3 to 5 percent slopes	12.20	7.6%	> 6.5ft.	IIle		4705	1	8	40		5	5	30	43	32		
BeA	Bethany silt loam, 0 to 1 percent slopes	4.74	2.9%	> 6.5ft.	IIs	Ile	4633	2	276	44		5	5	2	31	58	48	
W	Water	4.51	2.8%	> 6.5ft.	VIII		0											
KhB	Kingfisher-Wakita complex, 1 to 3 percent slopes	2.42	1.5%	2.5ft.	IIle		4116			28		4	4	21	46	33		
<b>Weighted Average</b>							<b>4199</b>	<b>9.6</b>	<b>22.2</b>	<b>14.8</b>		<b>4.2</b>	<b>3.2</b>	<b>11.4</b>	<b>17.5</b>	<b>*n 47.8</b>	<b>*n 38.6</b>	<b>*n</b>

\*n: The aggregation method is "Weighted Average using all components"

\*c: Using Capabilities Class Dominant Condition Aggregation Method

Soils data provided by USDA and NRCS.