

# Soils Map

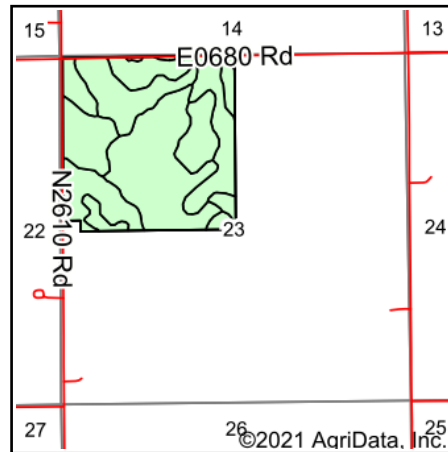

State: **Oklahoma**  
 County: **Blaine**  
 Location: **23-18N-11W**  
 Township: **Okeene**  
 Acres: **158.1**  
 Date: **4/9/2021**

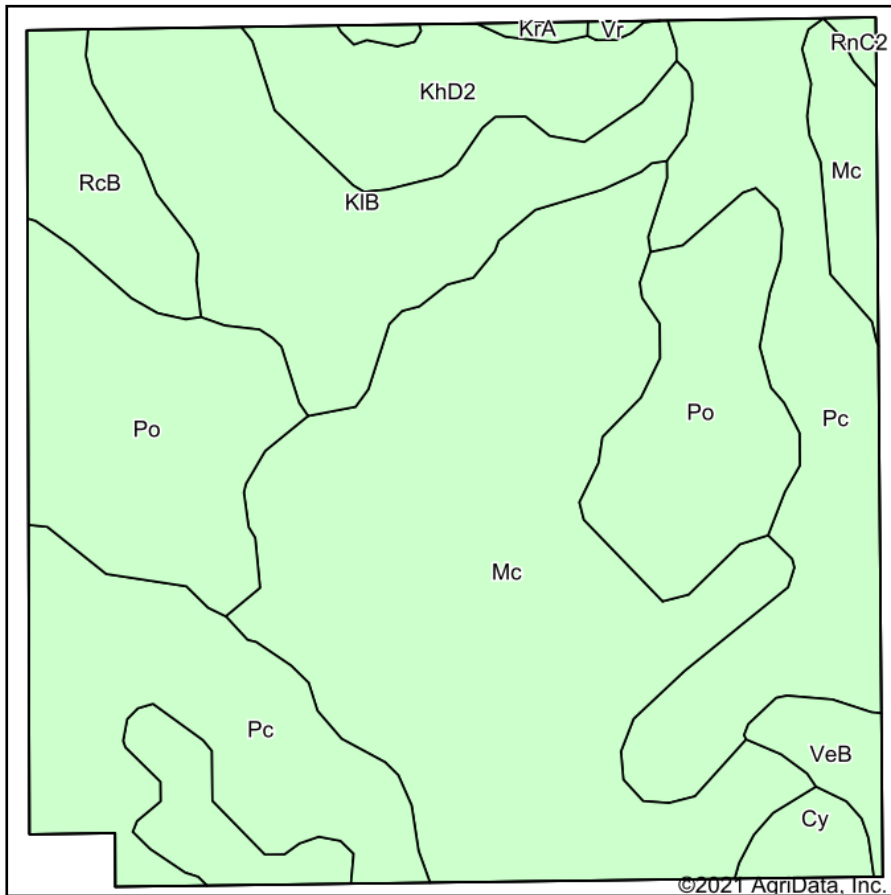

Maps Provided By:



© AgriData, Inc. 2021

www.AgriDataInc.com



Soils data provided by USDA and NRCS.

Area Symbol: OK011, Soil Area Version: 17

Code	Soil Description	Acres	Percent of field	Water Table	Non-Irr Class *c	Irr Class *c	Range Production (lbs/acre/yr)	Alfalfa hay	Barley	Cotton lint	Grain sorghum	Improved bermudagrass	Introduced bluestem	Oats	Peanuts	Sorghum hay
Mc	McLain silty clay loam, 0 to 1 percent slopes, rarely flooded	51.23	32.4%	> 6.5ft.	Iw		6100	5		500	56	9	6		85	
Pc	Port clay loam, 0 to 1 percent slopes, occasionally flooded	35.60	22.5%	> 6.5ft.	IIw		6127	5		13	49	9			48	
Po	Port loam, 0 to 1 percent slopes, occasionally flooded	26.44	16.7%	> 6.5ft.	IIw		6100	5			48	9				
KIB	Kingfisher-Huska complex, 1 to 3 percent slopes	19.85	12.6%	> 6.5ft.	Ile		4235				36	5	4			
KhD2	Kingfisher-Lucien complex, 3 to 8 percent slopes, eroded	9.81	6.2%	> 6.5ft.	IVe		0				1	3	2			
RcB	Renthin silty clay loam, 1 to 3 percent slopes	5.95	3.8%	> 6.5ft.	Ile		3901		36	38	36	5		41		



Cy	Beckman clay, 0 to 1 percent slopes, frequently flooded	5.57	3.5%	4.5ft.	Vw		1890					3				
VeB	Vernon clay loam, 1 to 3 percent slopes	2.42	1.5%	> 6.5ft.	Ills		1842		3		25			4	4	
KrA	Kirkland silt loam, 0 to 1 percent slopes	0.65	0.4%	> 6.5ft.	Ils	Ils	3926		2	51	35		4	5	32	
RnC2	Renthin-Grainola complex, 3 to 5 percent slopes, eroded	0.40	0.3%	> 6.5ft.	Ille		0		17		14		3		19	
Vr	Knoco-Badland complex, 5 to 15 percent slopes	0.18	0.1%	> 6.5ft.	Vlls		700									
<b>Weighted Average</b>							<b>5166.6</b>	<b>3.6</b>	<b>1.5</b>	<b>166.6</b>	<b>43.7</b>	<b>7.6</b>	<b>2.7</b>	<b>1.8</b>	<b>38.4</b>	

\*n: The aggregation method is "Weighted Average using all components"

\*c: Using Capabilities Class Dominant Condition Aggregation Method

Soils data provided by USDA and NRCS.