

# Soils Map

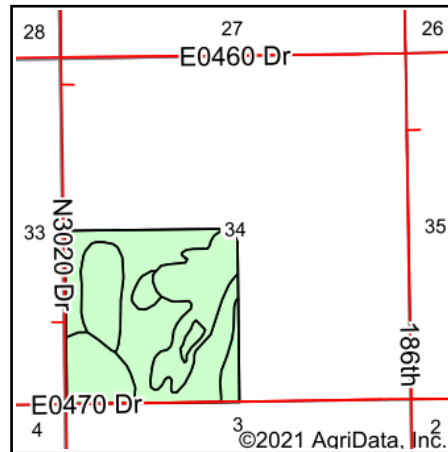

State: **Oklahoma**  
 County: **Garfield**  
 Location: **34-22N-4W**  
 Township: **South Garfield**  
 Acres: **158.67**  
 Date: **9/27/2021**

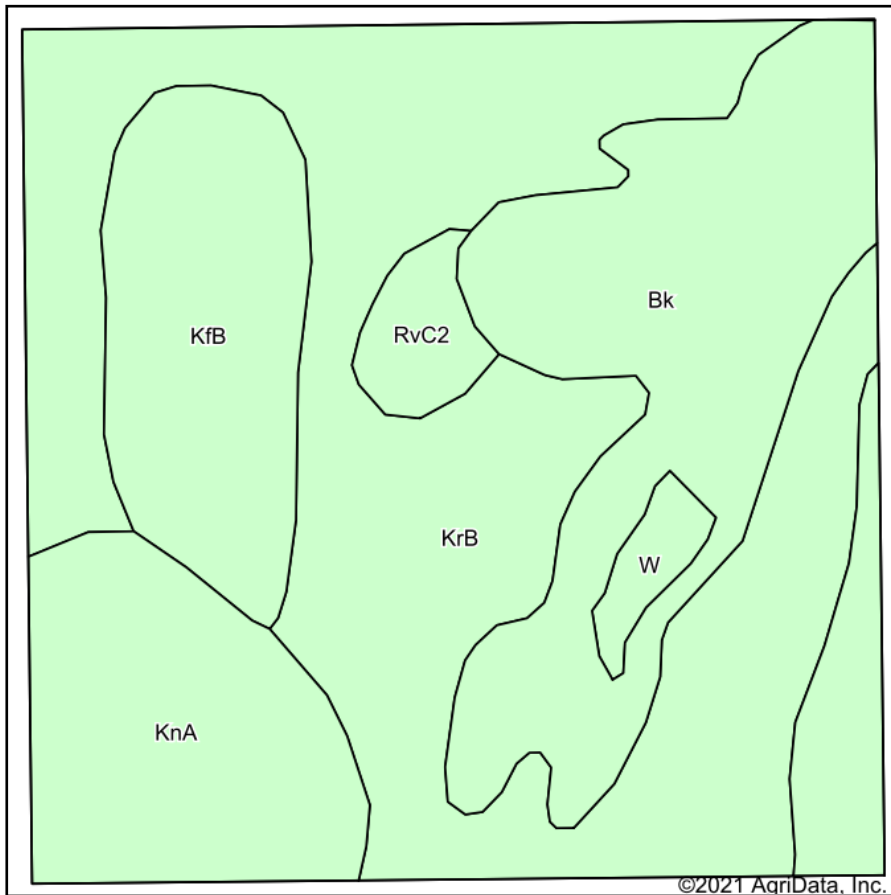

Soils data provided by USDA and NRCS.

Area Symbol: OK047, Soil Area Version: 17

Code	Soil Description	Acres	Percent of field	Non-Irr Class *c	Irr Class *c	Range Production (lbs/acre/yr)	Alfalfa hay	Barley	Cantaloupe	Cotton lint	Grain sorghum	Improved bermudagrass	Introduced bluestem	Oats	Peanuts
KrB	Kirkland-Renfrow complex, 1 to 3 percent slopes	71.46	45.0%	IIle		3901		12		238	32	4		2	
Bk	Grainola, Ashport frequently flooded, and Grant soils, 0 to 20 percent slopes	34.79	21.9%	VIle		4629						5	1		
KnA	Kirkland silt loam, 0 to 1 percent slopes, cool	26.58	16.8%	IIls	IIls	3890		4		22	35	4	5	34	
KfB	Grant silt loam, 1 to 3 percent slopes	19.90	12.5%	IIle		4579	2	1	5	8	48	6	6		51
RvC2	Renthin-Masham complex, 3 to 5 percent slopes, eroded	3.68	2.3%	IIle		237		15		15	17	4		18	
W	Water	2.26	1.4%	VIII		0									
<b>Weighted Average</b>						<b>4003.3</b>	<b>0.3</b>	<b>6.5</b>	<b>0.6</b>	<b>112.2</b>	<b>26.7</b>	<b>4.4</b>	<b>1.8</b>	<b>7</b>	<b>6.4</b>

\*n: The aggregation method is "Weighted Average using all components"

\*c: Using Capabilities Class Dominant Condition Aggregation Method

Soils data provided by USDA and NRCS.