

Soils Map

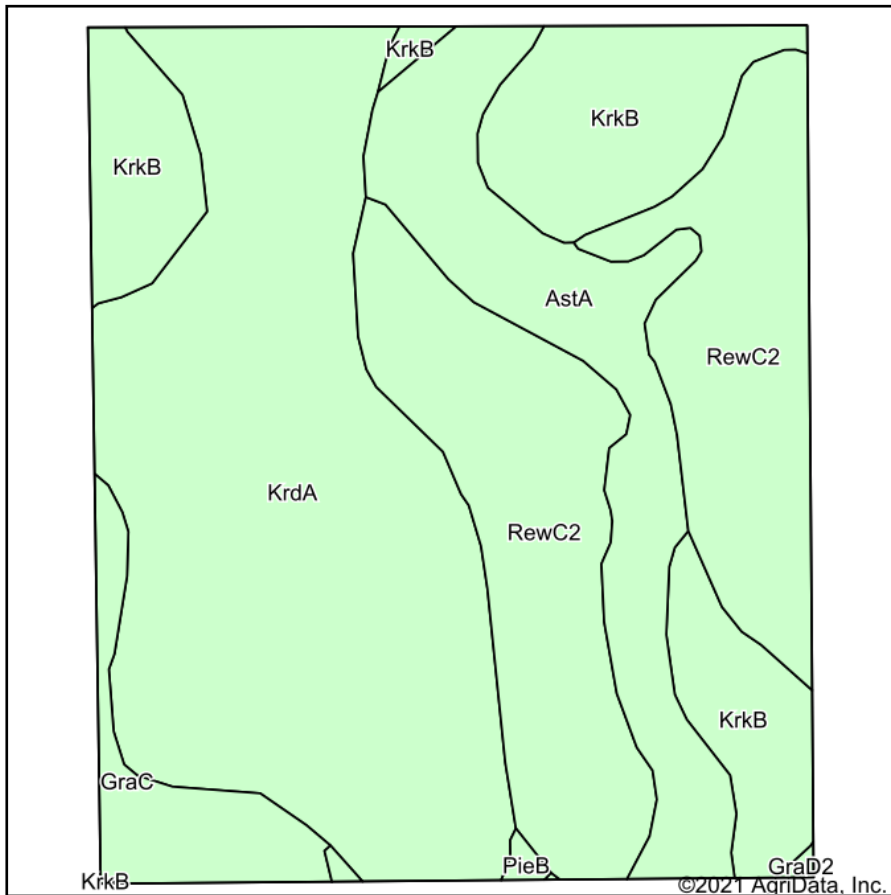

Soils data provided by USDA and NRCS.

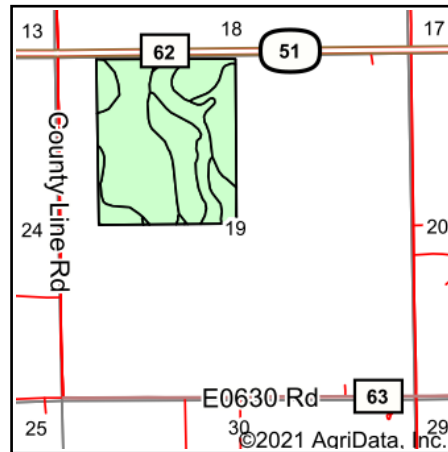

State: **Oklahoma**
 County: **Logan**
 Location: **19-19N-4W**
 Township: **North Logan**
 Acres: **121.9**
 Date: **11/9/2021**



Maps Provided By:



Area Symbol: OK083, Soil Area Version: 21

Code	Soil Description	Acres	Percent of field	Non-Irr Class *c	Irr Class *c	Range Production (lbs/acre/yr)	Alfalfa hay Tons	Barley Bu	Caucasian bluestem AUM	Cotton lint Lbs	Grain sorghum Bu	Improved bermudagrass AUM	Introduced bluestem AUM	Oats Bu	Sorghum hay Tons
KrdA	Kirkland silt loam, 0 to 1 percent slopes	47.45	38.9%	Ils	Ils	3926		2		51	35	4	5	32	
RewC2	Renfrow silty clay loam, 3 to 5 percent slopes, eroded	32.78	26.9%	IVe		0						3			
KrkB	Kirkland silty clay loam, 1 to 3 percent slopes	19.70	16.2%	IIIe		3853	2				34	4	5	1	
AstA	Ashport silt loam, 0 to 1 percent slopes, frequently flooded	16.11	13.2%	Vw		6229			10			9	8		
GraC	Grainola silty clay loam, 3 to 5 percent slopes	5.33	4.4%	IIIe		3724		1			16	2	3	1	
PieB	Piedmont silty clay loam, 1 to 3 percent slopes	0.40	0.3%	IIIs		3849	2				29	4	5		
GraD2	Grainola silty clay loam, 5 to 8 percent slopes, eroded	0.13	0.1%	IVe		0					1	3	3		



Weighted Average	3.15	0.78	3149.6	0.3	0.8	1.3	19.9	19.9	4.3	4	12.7	1
-------------------------	-------------	-------------	---------------	------------	------------	------------	-------------	-------------	------------	----------	-------------	----------

*n: The aggregation method is "Weighted Average using all components"

*c: Using Capabilities Class Dominant Condition Aggregation Method

Soils data provided by USDA and NRCS.