

Soils Map

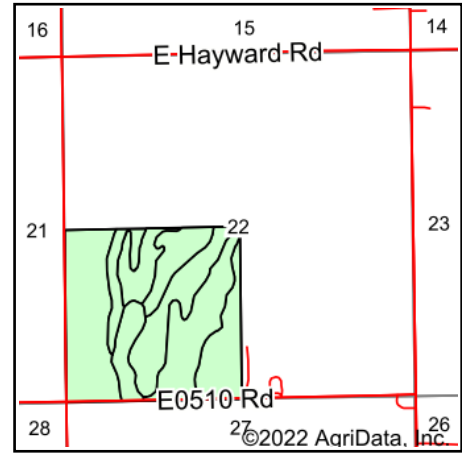

State: **Oklahoma**
 County: **Garfield**
 Location: **22-21N-5W**
 Township: **South Garfield**
 Acres: **162.43**
 Date: **4/5/2022**

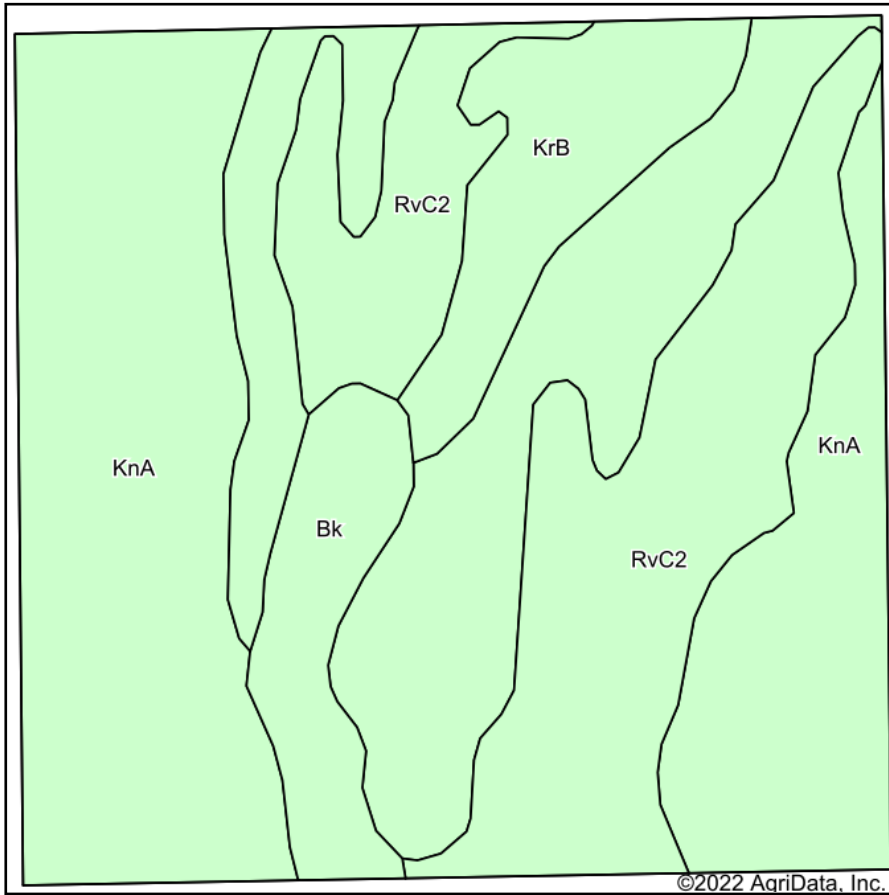

Maps Provided By:



Soils data provided by USDA and NRCS.

Area Symbol: OK047, Soil Area Version: 18

Code	Soil Description	Acres	Percent of field	Non-Irr Class *c	Irr Class *c	Range Production (lbs/acre/yr)	Barley Bu	Cotton lint Lbs	Grain sorghum Bu	Improved bermudagrass AUM	Introduced bluestem AUM	Oats Bu	Sorghum hay Tons	Weeping lovegrass AUM	Wheat Bu	W g A
KnA	Kirkland silt loam, 0 to 1 percent slopes, cool	88.40	54.4%	IIs	IIs	3890	4	22	35	4	5	34	5		34	
RvC2	Renthin-Masham complex, 3 to 5 percent slopes, eroded	41.61	25.6%	IIle		237	15	15	17	4		18				16
KrB	Kirkland-Renfrow complex, 1 to 3 percent slopes	22.07	13.6%	IIle		3901	12	238	32	4		2		3		28
Bk	Grainola, Ashport frequently flooded, and Grant soils, 0 to 20 percent slopes	10.35	6.4%	VIle		4629				5	1			1		
Weighted Average				2.65	1.09	3002.8	7.7	48.2	27.8	4.1	2.8	23.4	2.7	0.5	26.4	

*n: The aggregation method is "Weighted Average using all components"

*c: Using Capabilities Class Dominant Condition Aggregation Method

Soils data provided by USDA and NRCS.