

Soils Map

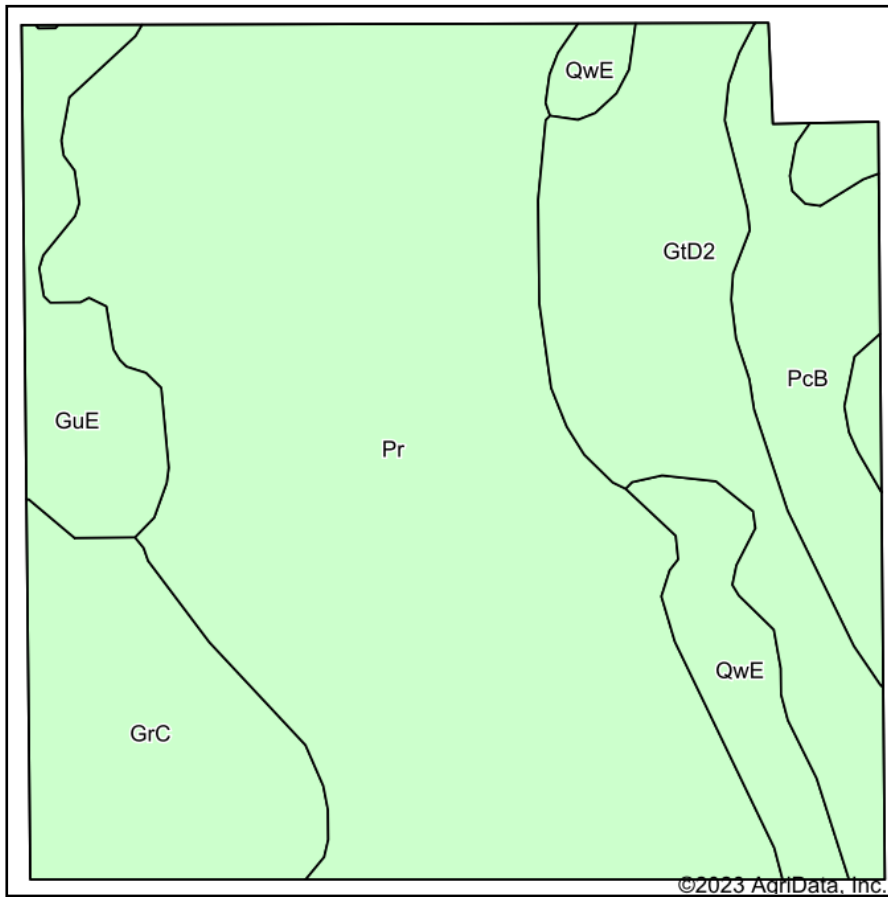

Soils data provided by USDA and NRCS.

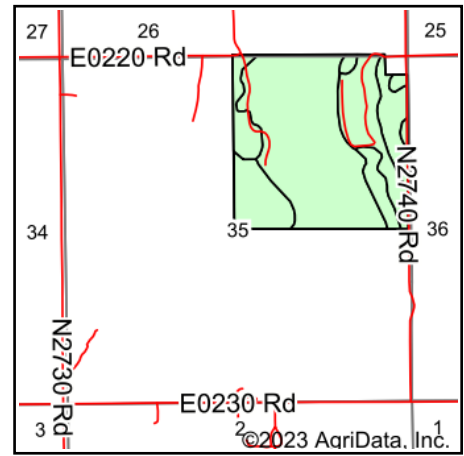

State: **Oklahoma**
 County: **Alfalfa**
 Location: **35-26N-9W**
 Township: **North Alfalfa**
 Acres: **158.36**
 Date: **3/29/2023**



Maps Provided By:



Area Symbol: OK003, Soil Area Version: 22

Code	Soil Description	Acres	Percent of field	Non-Irr Class *c	Irr Class *c	Range Production (lbs/acre/yr)	Alfalfa hay Tons	Barley Bu	Caucasian bluestem AUM	Cotton lint Lbs	Grain sorghum Bu	Improved bermudagrass AUM	Introduced bluestem AUM	Peanuts Lbs	Tall wheatg AUM
Pr	Port silt loam, 0 to 1 percent slopes, occasionally flooded	85.59	54.0%	IIw		5795	5			13	49	9		48	
GtD2	Grant-Nash complex, 3 to 8 percent slopes, eroded	26.02	16.4%	IVe		0		7		23	9	4	3		
GrC	Grant silt loam, 3 to 5 percent slopes	17.29	10.9%	IIIe		4510	2			23	48	6	6		
PcB	Pond Creek silt loam, 1 to 3 percent slopes	11.92	7.5%	Ie	Ie	4747	4			32	50	5	5	85	
GuE	Grant-Port, frequently flooded, complex, 0 to 12 percent slopes	9.12	5.8%	VIe		5064	1	2	3	44	30	5	5		
QwE	Quinlan-Woodward complex, 5 to 30 percent slopes	8.42	5.3%	VIIe		3122				25	3	3	2		
Weighted Average				2.86	*-	4439.4	3.3	1.3	0.2	19.6	38.9	7	1.9	32.3	

*n: The aggregation method is "Weighted Average using all components"

*c: Using Capabilities Class Dominant Condition Aggregation Method

*- Irr Class weighted average cannot be calculated on the current soils data due to missing data.

Soils data provided by USDA and NRCS.