

Soils Map

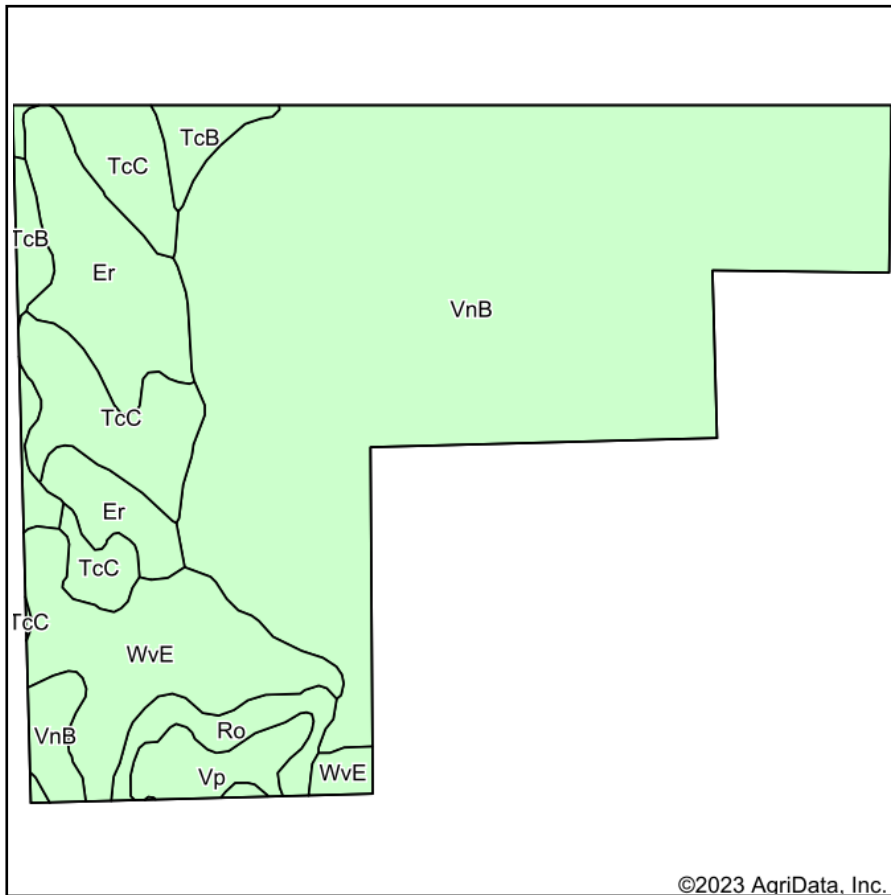

Soils data provided by USDA and NRCS.

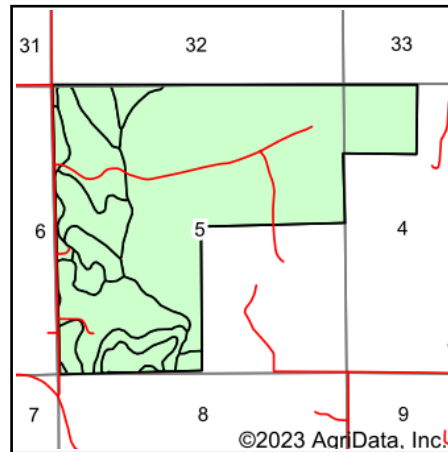

State: **Oklahoma**
 County: **Major**
 Location: **5-21N-13W**
 Township: **Fairview**
 Acres: **501.82**
 Date: **7/17/2023**



Maps Provided By:



Area Symbol: OK093, Soil Area Version: 17

Code	Soil Description	Acres	Percent of field	Non-Irr Class *c	Irr Class *c	Range Production (lbs/acre/yr)	Cotton lint Lbs	Cotton lint Irrigated Lbs	Grain sorghum Bu	Grain sorghum Irrigated Bu	Wheat Bu	Wheat Irrigated Bu	*n NCCPI Overall	*n NCCPI Corn	*n NCCPI Small Grains	*n NCCPI Soybeans
VnB	Knoco-Badland complex, 1 to 3 percent slopes	320.59	63.9%	Vlls		650							8	5	6	8
WvE	Burford-Vernon complex, 5 to 12 percent slopes	49.62	9.9%	llle	llle	2895							38	28	25	38
Er	Burford clay loam, 3 to 8 percent slopes, severely eroded	45.96	9.2%	IVe		0							41	33	25	39
TcC	Tillman clay loam, 3 to 5 percent slopes	45.07	9.0%	llle	llle	1912	300	750	30	75	30	50	47	34	28	47
TcB	Tillman clay loam, 1 to 3 percent slopes	15.60	3.1%	lle	lle	1872	300	750	30	75	30	50	46	29	27	45
Ro	Knoco-Rock outcrop complex, 20 to 40 percent slopes	12.76	2.5%	Vllle		455							2	2	2	2



Vp	Knoco-Cornick-Rock outcrop complex, 2 to 20 percent slopes	12.22	2.4%	Vlls		1330							15	11	7	1
Weighted Average				5.82	*-	975.4	36.3	90.7	3.6	9.1	3.6	6	*n 18.7	*n 13.3	*n 12.2	*n 18.

*n: The aggregation method is "Weighted Average using all components"

*c: Using Capabilities Class Dominant Condition Aggregation Method

*- Irr Class weighted average cannot be calculated on the current soils data due to missing data.

Soils data provided by USDA and NRCS.