

# Soils Map

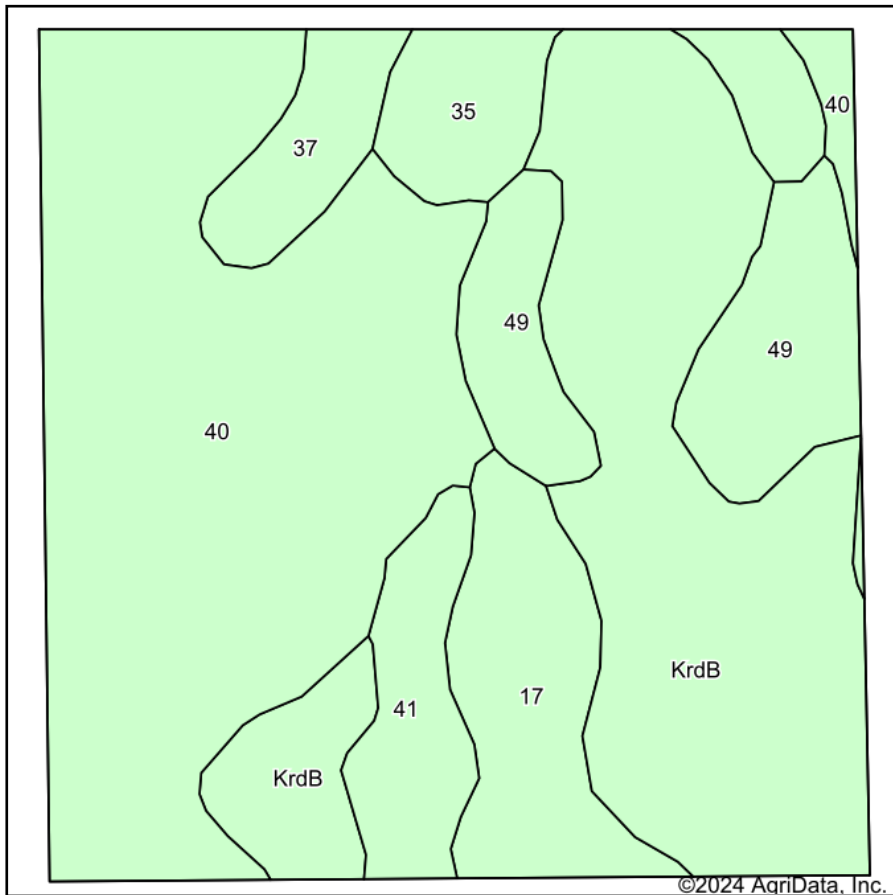

Soils data provided by USDA and NRCS.

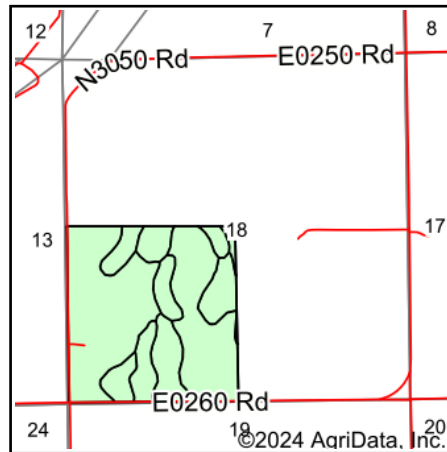

State: **Oklahoma**  
 County: **Grant**  
 Location: **18-25N-3W**  
 Township: **Lamont**  
 Acres: **157.51**  
 Date: **5/13/2024**



Maps Provided By:



Area Symbol: OK053, Soil Area Version: 20

Code	Soil Description	Acres	Percent of field	Water Table	Non-Irr Class *c	Irr Class *c	Range Production (lbs/acre/yr)	Alfalfa hay Tons	Barley Bu	Cantaloupe AUM	Cotton lint Lbs	Grain sorghum Bu	Improved bermudagrass AUM	Introduced bluestem AUM	Oats Bu
40	Pond Creek silt loam, 1 to 3 percent slopes	61.25	38.9%	> 6.5ft.		I	4747	4			32	50	5	5	
KrdB	Kirkland silt loam, 1 to 3 percent slopes	47.23	30.0%	> 6.5ft.	IIs	IIs	3926		2		50	34	4	5	32
49	Renfrow silty clay loam, 3 to 5 percent slopes, eroded	15.06	9.6%	> 6.5ft.	IVe		0						3		
17	Grant silt loam, 1 to 3 percent slopes	12.36	7.8%	> 6.5ft.	Ile		4579	2	1	5	8	48	6	6	
35	McLain-Drummond complex, 0 to 1 percent slopes, rarely flooded	8.50	5.4%	3ft.	Is		5910	3			75	32	6	2	

Soils data provided by USDA and NRCS.



Code	Soil Description	Acres	Percent of field	Water Table	Non-Irr Class *c	Irr Class *c	Range Production (lbs/acre/yr)	Alfalfa hay Tons	Barley Bu	Cantaloupe AUM	Cotton lint Lbs	Grain sorghum Bu	Improved bermudagrass AUM	Introduced bluestem AUM	Oats Bu
41	Port silt loam, 0 to 1 percent slopes, occasionally flooded	7.64	4.9%	> 6.5ft.	Ilw	Ilw	5795	5			13	49	9		
37	Norge silt loam, 3 to 5 percent slopes, eroded	5.48	3.5%	> 6.5ft.	Ille		300	2		9	255	35	5	4	
<b>Weighted Average</b>					<b>1.78</b>	<b>*-</b>	<b>3992.9</b>	<b>2.2</b>	<b>0.7</b>	<b>0.7</b>	<b>41.6</b>	<b>38.7</b>	<b>4.8</b>	<b>4.2</b>	<b>9.6</b>

\*n: The aggregation method is "Weighted Average using all components"

\*c: Using Capabilities Class Dominant Condition Aggregation Method

\*- Irr Class weighted average cannot be calculated on the current soils data due to missing data.