

Topography Map

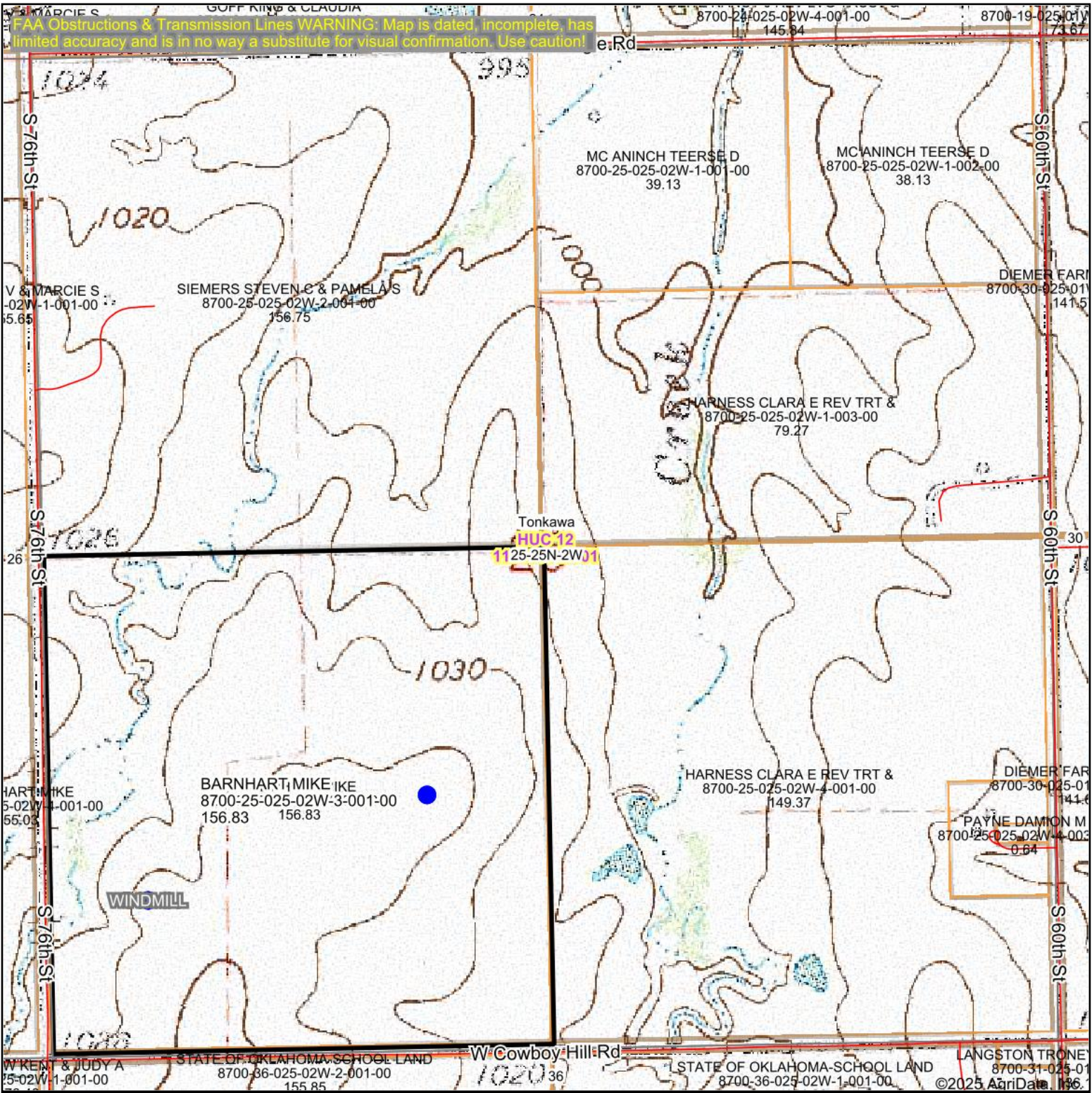

FAA Obstructions & Transmission Lines WARNING: Map is dated, incomplete, has limited accuracy and is in no way a substitute for visual confirmation. Use caution!

Map Center: 36° 36' 55.71", -97° 21' 49.15"

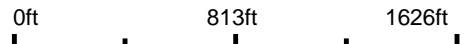

25-25N-2W
Kay County
Oklahoma

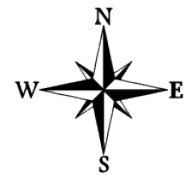

2/6/2025



Watershed Boundary Dataset provided by USDA-NRCS, USGS and EPA