

Soils Map

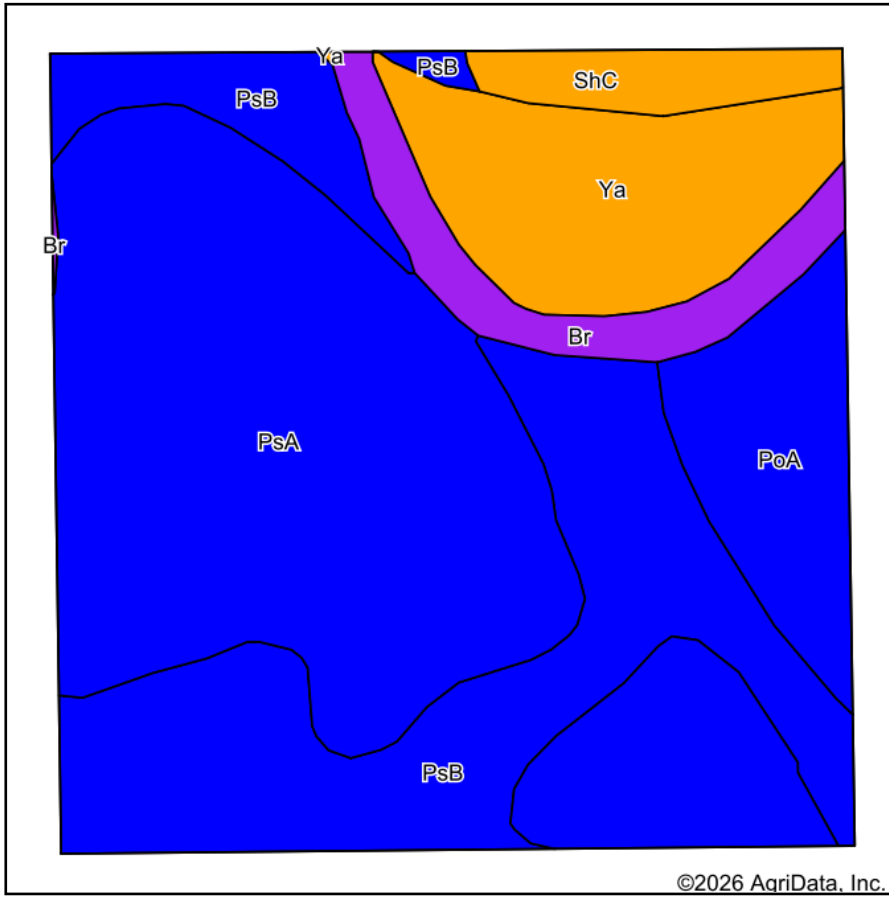

Soils data provided by USDA and NRCS.

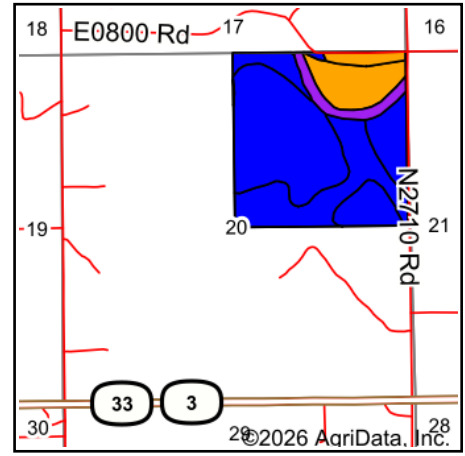

State: **Oklahoma**
 County: **Kingfisher**
 Location: **20-16N-9W**
 Township: **Kingfisher**
 Acres: **159.27**
 Date: **2/16/2026**

LRA LIPPARD
 REAL ESTATE AND AUCTION

Maps Provided By:



Area Symbol: OK073, Soil Area Version: 21

Code	Soil Description	Acres	Percent of field	Non-Irr Class Legend	Non-Irr Class *c	Irr Class *c	Range Production (lbs/acre/yr)	Alfalfa hay Tons	Cantaloupe Crates	Caucasian bluestem AUM	Cotton lint Lbs	Grain sorghum Bu	Improved bermudagrass AUM	Introduced bluestem AUM
PsA	Port silt loam, 0 to 1 percent slopes, occasionally flooded	59.61	37.5%		Ilw	Ilw	5795	5			13	49	9	
PsB	Dale silt loam, 1 to 3 percent slopes, rarely flooded	43.23	27.1%		Ile		6100	5		1	53	46	8	1
PoA	Ashport clay loam, 0 to 1 percent slopes, occasionally flooded	24.24	15.2%		Ilw	Ilw	5490	5		10		45	8	8
Ya	Yahola fine sandy loam, 0 to 1 percent slopes, occasionally flooded	18.81	11.8%		Ille		5995		227	6	383	49	7	5

Soils data provided by USDA and NRCS.

Code	Soil Description	Acres	Percent of field	Non-Irr Class Legend	Non-Irr Class *c	Irr Class *c	Range Production (lbs/acre/yr)	Alfalfa hay Tons	Cantaloupe Crates	Caucasian bluestem AUM	Cotton lint Lbs	Grain sorghum Bu	Improved bermudagrass AUM	Introduced bluestem AUM
Br	Ashport, Port and Pulaski soils, 0 to 1 percent slopes, frequently flooded	8.33	5.2%		Vw		6247						8	
ShC	Lovedale fine sandy loam, 3 to 5 percent slopes	5.05	3.2%		Ille		3223	3				44	6	5
Weighted Average					2.31	*-	5797.1	4.1	26.8	2.5	64.5	44.9	8.2	2.2

*n: The aggregation method is "Weighted Average using all components"

*c: Using Capabilities Class Dominant Condition Aggregation Method

*- Irr Class weighted average cannot be calculated on the current soils data due to missing data.